

FIELD COPY

COUNTY OF LOS ANGELES

ROAD DEPARTMENT

PRECISE

BENCH MARK LIST



LANCASTER QUAD

1972 ADJUSTMENT

FIELD COPY

PREFACE

The Road Department level net is composed of more than 1,000 miles of levels supporting in excess of 10,000 bench marks. In 1964-65, a major readjustment of the net was undertaken. To emphasize the complete break with previous elevations, the SY, SG & SL series bench marks have been re-labeled BY, BG & BL, respectively.

To facilitate the adjustment, indexing, and distribution of adjusted values of the net, the County territory was divided into 31 quads or areas. For identification purposes each quad was given a name, viz., "Rosemead," "La Mirada," "Santa Fe," etc. When bench marks and elevations in the Road Department net are used, the name of the quad in which the bench mark is located and the date of the adjustment of the elevation must be included in the bench mark description, e.g.,

BG 1887 --L+BN IN CONC HDWL OF DRAIN PIPE UNDER DR 218 FT
NE +18 FT SE C/L INT GRAND AVE +CAMERON AVE MKD (BM)
(COVINA --1965) ELEV. 696.238

It is expected that this general adjustment will, for the most part, remain sound for the next 8 to 12 years. As new circuits are completed, however, re-adjustment of individual quads may become advisable. It is expected that these subsequent adjustments will be in the nature of a few hundredths of a foot. When a quad is re-adjusted, new elevation lists will be published and the date of the re-adjustment will replace the "1965" at the end of the bench mark description. Two bench marks in the same quad with different adjustment dates will not normally join each other. Since all adjustments taper out to nothing at the periphery of the quad, any bench mark in one quad will join any bench mark in another quad regardless of their respective adjustment dates.

The basic accuracy of the net is reflected by an indicated field probable error of plus or minus 0.012 foot per mile of leveling as determined from 298 conditions of closure. However, many years experience in vertical control in the greater Los Angeles basin and Antelope Valley indicate that because of varying degrees of subsidence and heaving, the true datum is recovered only by obtaining substantial agreement of a number of bench marks.

The users of this net are invited to assist in its maintenance by notifying this Department of cases of obliteration, apparent mistakes in descriptions or elevations, and proven disturbance of bench marks.

DATUM: U. S. Coast and Geodetic Survey Sea Level Datum
of 1929, through the medium of the Los Angeles
County Engineer Precise Level Net, 1963 Adjust-
ment.

ABBREVIATIONS USED IN BENCH MARK LISTINGS

ABUT - - - - -	Abutment	EC - - - - -	End of Curve
ALG - - - - -	Along	ENT - - - - -	Entrance
ANG PT - - - - -	Angle Point	FL - - - - -	Floor
B/W - - - - -	Back of Walk	FTG - - - - -	Footing
BCR - - - - -	Beginning of Curb Return	F/W - - - - -	Front of Walk
BC - - - - -	Beginning of Curve	GAR - - - - -	Garage
BLDG - - - - -	Building	HDWL - - - - -	Headwall
BM - - - - -	Bench Mark	HSE - - - - -	House
BT SPK - - - - -	Boat or Bolt Spike	INT - - - - -	Intersection
BR CAP - - - - -	Brass or Bronze Cap	IP - - - - -	Iron Pipe
C B - - - - -	Catch Basin	LT - - - - -	Left
CTR - - - - -	Center	LACE - - - - -	L. A. City Engineer
C/L - - - - -	Center Line	LACS - - - - -	L. A. County Engineer
C/L INT - - - - -	Center Line Intersection	LAFC - - - - -	L. A. Co. Flood Control
C/L PROD - - - - -	Center Line Produced	L+BN - - - - -	Lead and Bench Nail
CONC - - - - -	Concrete	L+BR - - - - -	Lead and Brad
COR - - - - -	Corner	L+N - - - - -	Lead and Nail
COE - - - - -	Corps of Engineers	L+RDEM TAG - - - - -	Lead and Road Dept. Bench Mark Tag
CULV - - - - -	Culvert	L+SPK - - - - -	Lead and Spike
CB - - - - -	Curb	L+T - - - - -	Lead and Tack
CS MON - - - - -	County Engineer Monument	MCR - - - - -	Middle of Curb Return
CS BR CAP - - - - -	County Engineer Brass Cap	MKD - - - - -	Marked
CT SPK - - - - -	Cut Spike	MC - - - - -	Middle of Curve
DR - - - - -	Drive or Driveway	MON - - - - -	Monument
E/O - - - - -	East of	N/O - - - - -	North of
ECR - - - - -	End of Curb Return	NR - - - - -	Near

ABBREVIATIONS USED IN BENCH MARK LISTINGS . . . CONTINUED

OPP - - - - - Opposite
PI - - - - - Point of Intersection
PK+W - - - - - PK Nail and Washer
P/L - - - - - Property Line
POST - - - - - Point on Semi-Tangent
PP - - - - - Power Pole
PVMT - - - - - Pavement
PROD - - - - - Produced
RD - - - - - Road
RDEM - - - - - Road Dept. Bench Mark
RR - - - - - Railroad
RT - - - - - Right
R/W - - - - - Right of Way
SDMH - - - - - Storm Drain Manhole
SMH - - - - - Sewer Manhole
SPK - - - - - Spike
ST+W - - - - - Spike Tin and Washer
S/O - - - - - South of
TP - - - - - Telephone Pole
USC+GS - - - - - U. S. Coast and Geodetic Survey
USGS - - - - - U. S. Geological Survey
WK - - - - - Walk
W/O - - - - - West of

C O U N T Y

L A N C A S T E R
Q U A D

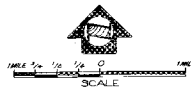

V I S T A
H I
L L A N D
Q U A D

P A L M D A L E

Q U A D

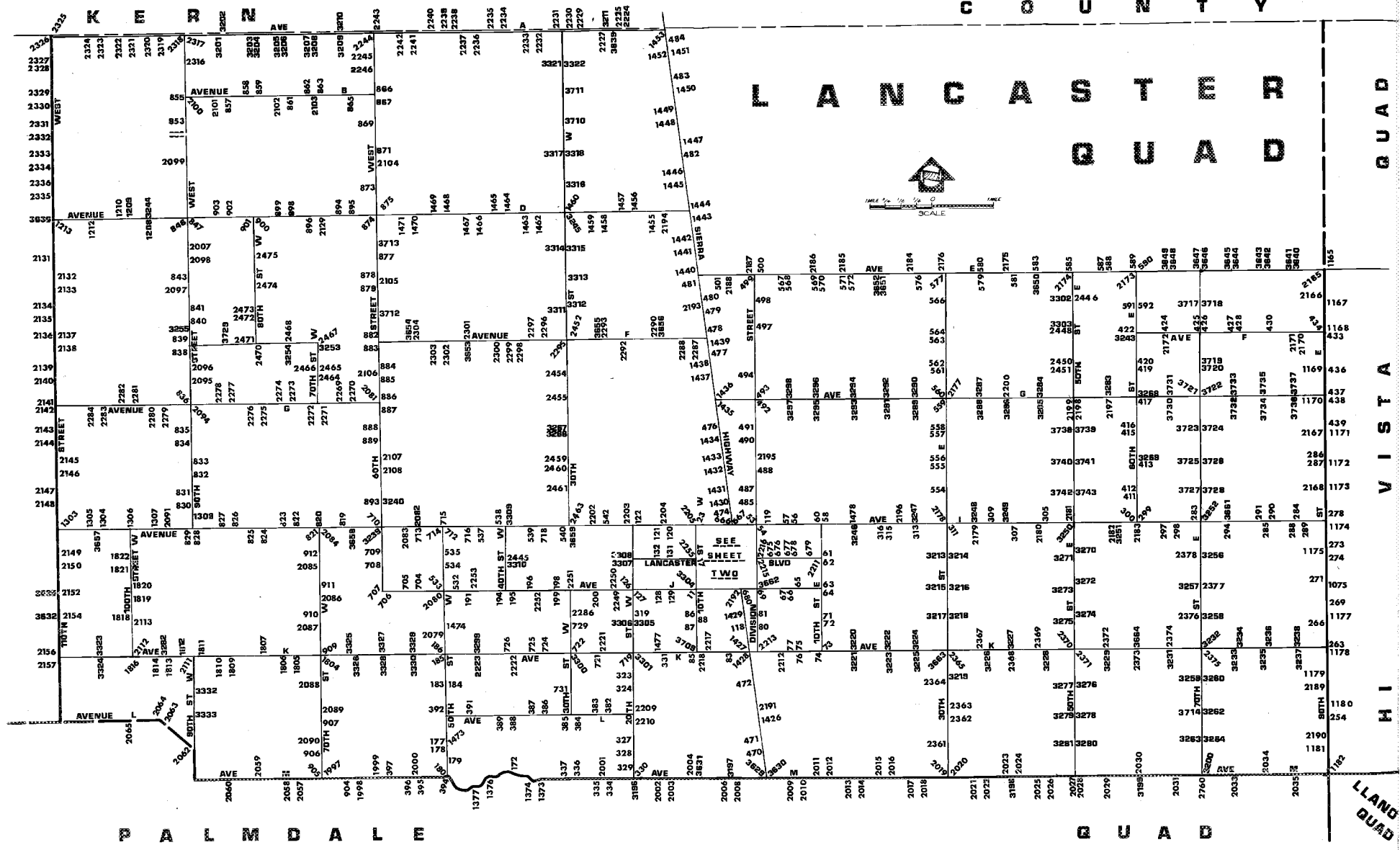

QUAD-YEAR	ELEV	DESCRIPTION (INCLUDE QUAD AND YEAR IN DESCRIPTION)	BM NUMBER
LANCASTR (1972)	2359.602	L+T MCR @ SE COR BEECH AVE + NEWGROVE ST 22FT E + 23FT S C/L INT	BL 2
LANCASTR (1972)	2361.207	L+T E CB CEDAR AVE 20FT E C/L + 35FT S C/L NEWGROVE ST	BL 3
LANCASTR (1972)	2364.838	L+BN MCR NW COR CEDAR AVE + OLDFIELD ST 24FT N + 24FT W C/L INT	BL 4
LANCASTR (1972)	2368.425	L+T MCR NW COR CEDAR AVE + PILLSBURY ST 23FT N + 22FT W C/L INT	BL 5
LANCASTR (1972)	2368.747	L+BN W CB 1FT N BCR @ NW COR ELM AVE + AVE J 18FT W + 66FT N C/L INT	BL 7
LANCASTR (1972)	2367.043	WLY L+T S CB AVE J 60FT S C/L ON C/L PROD FERN AVE IN FRONT OF PARK VIEW SCHOOL	BL 9
LANCASTR (1972)	2360.251	L+BN MCR SW COR AVE J + TENTH ST W 57FT S + 50FT W C/L INT	BL 11
LANCASTR (1972)	2345.646	L+T IN CONC SLAB 69FT E + 104FT N LANCASTER BLVD + TENTH ST W OUT	BL 17
LANCASTR (1972)	2337.975	L+BN W CB 10TH ST W 28FT W C/L 3FT N OF S P/L BLDG 44913 + 570FT S JACKMAN ST 3FT N PP 271449E	BL 18
LANCASTR (1972)	2337.222	L+BN E CB 10TH ST W 28FT E C/L + 86FT N OF N EDGE DRWY BLDG 44902 480FT S JACKMAN ST	BL 19
LANCASTR (1972)	2335.507	L+T IN CB RET 10FT N BCR @ SW COR 10TH ST W + JACKMAN ST 33FT S + 30FT W C/L INT	BL 20
LANCASTR (1972)	2329.737	L+T MCR @ NW COR AVE I + 10TH ST W 50FT N + 39FT W C/L INT	BL 23
LANCASTR (1972)	2331.791	L+T N CB AVE I 40FT N C/L ON C/L PROD FERN AVE	BL 24
LANCASTR (1972)	2334.849	L+T N CB AVE I 40FT N C/L ON C/L PROD ALLEY W OF DATE AVE	BL 25
LANCASTR (1972)	2335.383	L+T N CB AVE I 40FT N C/L ON C/L PROD CEDAR AVE	BL 27
LANCASTR (1972)	2339.495	L+T W CB DATE AVE 0.5FT N BCR @ NW COR DATE AVE + JACKMAN ST 33FT N + 18FT W C/L INT	BL 30
LANCASTR (1972)	2340.123	L+BN S CB JACKMAN ST 20FT S C/L + 25FT W C/L ALLEY TO S BETWEEN FIG AVE + ELM AVE 5FT W BCR	BL 31
LANCASTR (1972)	2339.530	L+BN S CB JACKMAN ST 6FT W BCR @ SW COR FIG AVE + JACKMAN ST 20FT S + 52FT W C/L INT	BL 32
LANCASTR (1972)	2350.223	L+T CONC STEP HSE NO 45027 N DIVISION ST 295FT N + 54FT W C/L INT KETTERING ST + DIVISION ST	BL 34
LANCASTR (1972)	2347.554	L+BN W CB YUCCA AVE 6FT N BCR @ NW COR YUCCA AVE + KETTERING ST 60FT N + 34FT W C/L INT	BL 38
LANCASTR (1972)	2348.535	L+T CONC BASE FENCE POST 30FT N OF C/L KETTERING ST + 209FT W C/L YUCCA AVE	BL 39
LANCASTR (1972)	2346.220	L+BRAD E CB SIERRA HWY 30FT E C/L + 25FT N C/L KETTERING ST	BL 40
LANCASTR (1972)	2346.556	L+T IN SW CB RET 26FT S C/L KETTERING ST + 30FT W C/L SIERRA HWY	BL 41

QUAD-YEAR	ELEV	DESCRIPTION (INCLUDE QUAD AND YEAR IN DESCRIPTION)	BM NUMBER
LANCASTR (1972)	2372.340	L+T IN CONC APRON IN NE COR GROCERY STORE @ SW COR NUGENT ST + DIVISION ST 23FT S + 33FT W C/L INT	BL 44
LANCASTR (1972)	2364.096	CS BR CAP MON @ C/L INT OF DIVISION ST + NEWGROVE ST (E EDGE)	BL 47
LANCASTR (1972)	2359.728	CS MON (E EDGE) IN WELL @ C/L INT NEWGROVE ST TO E + TREVOR AVE	BL 49
LANCASTR (1972)	2362.145	L+BN E CB SIERRA HWY 25FT E C/L + 115FT S C/L PROD NEWGROVE ST 16FT S OF END CB	BL 51
LANCASTR (1972)	2361.400	L+T @ MCR SW COR NEWGROVE ST + SIERRA HWY 23FT S + 37FT W C/L INT	BL 52
LANCASTR (1972)	2344.133	L+T @ MCR NW COR AVE I + DIVISION ST 42FT N + 43FT W C/L INT	BL 53
LANCASTR (1972)	2344.233	L+T @ MCR SW COR AVE I + DIVISION ST 42FT S + 44FT W C/L INT	BL 54
LANCASTR (1972)	2353.631	CSBM MON IN CONC FLUSH 1FT N OF N CB + 19FT W BCR @ NW COR 5TH ST E + AVE I 41FT N + 82FT W C/L INT MKD (BM 105-20 1958)	BL 56
LANCASTR (1972)	2353.473	L+T N CB 3FT W BCR 40FT N + 62FT W C/L INT AVE I + 5TH ST E	BL 57
LANCASTR (1972)	2360.541	USC+GS BR CAP IN CONC POST 8IN UP 48FT N + 56FT E C/L INT AVE I + 10TH ST E MKD (Z1155, 1961)	BL 58
LANCASTR (1972)	2360.532	USC+GS BR CAP 78FT W + 40FT S C/L INT AVE I + 10TH ST E MKD (Y 488 RESET 1961)	BL 60
LANCASTR (1972)	2377.554	CS MON IN WELL 36IN DN @ C/L INT LANCASTER BLVD + 10TH ST E MKD (1/4 COR 14 13 T7N R12W)	BL 61
LANCASTR (1972)	2380.912	L+T W EDGE OF CONC DR OF GARAGE TO HSE NO 1016 LANCASTER BLVD 45FT S C/L + 145FT E C/L 10TH ST E	BL 62
LANCASTR (1972)	2397.495	L+T NR MCR @ SW COR 10TH ST E + AVE J 48FT W + 45FT S C/L INT	BL 63
LANCASTR (1972)	2396.461	CS MON IN WELL 18IN DN @ C/L INT AVE J + 10TH ST E MKD (SEC COR 14 13 23 24 T7N R12W)(W EDGE)	BL 64
LANCASTR (1972)	2391.290	CS MON IN WELL @ C/L INT AVE J + 5TH ST E MKD (T7N R12W 1/4 COR 14 23)(E EDGE)	BL 65
LANCASTR (1972)	2384.641	L+BN @ MCR SE COR 4TH ST E + AVE J (SERVICE RD) 80FT S + 24FT E C/L INT	BL 66
LANCASTR (1972)	2383.759	L+BN @ MCR SE COR KIRKLAND AVE + AVE J 75FT S + 27FT E C/L INT	BL 67
LANCASTR (1972)	2380.268	CS MON (N EDGE) IN WELL @ C/L INT AVE J + DIVISION ST MKD (15 14 22 23 T7N R12W)	BL 69
LANCASTR (1972)	2413.367	L+T E SIDE 36IN STANDPIPE 215FT W C/L 10TH ST E + 5FT N C/L AVE J-8 263FT NW PP 917614E	BL 71
LANCASTR (1972)	2414.013	CS MON IN WELL 8IN DN @ C/L INT 10TH ST E + AVE J-8 0.5 MI S AVE J MKD (T7N, R12W 1/4 COR, 23-24)(W EDGE)	BL 72
LANCASTR (1972)	2434.604	CS MON IN WELL 15IN DN @ C/L INT 10TH ST E + AVE K MKD (SEC COR 23 24 25 26 T7N R12W)(N EDGE)	BL 73

QUAD-YEAR	ELEV	DESCRIPTION (INCLUDE QUAD AND YEAR IN DESCRIPTION)	BM NUMBER
LANCASTR (1972)	2436.043	CHIS X IN TOP OF BOLT ON S SIDE OF FIRE HYDRANT BASE 50FT W C/L 10TH ST E + 28FT S C/L AVE K	BL 74
LANCASTR (1972)	2425.923	CS MON IN WELL @ C/L INT AVE K + 6TH ST E (W EDGE)	BL 75
LANCASTR (1972)	2426.539	CS MON IN CONC POST 3IN UP 40FT S + 55FT W C/L INT AVE K + 6TH ST E MKD (BM 105-9 1958)	BL 76
LANCASTR (1972)	2425.475	CHIS X IN TOP OF BOLT ON W SIDE OF FIRE HYDRANT BASE 24FT S + 40FT W C/L INT AVE K + 5TH ST E 135FT W DRWY TO HSE 504	BL 77
LANCASTR (1972)	2400.549	L+BN @ MCR @ NE COR DIVISION ST + AVE J-8 28FT N + 41FT E C/L INT	BL 80
LANCASTR (1972)	2399.353	L+BN @ MCR SE COR DIVISION ST + AVE J-7 36FT S + 35FT E C/L INT	BL 81
LANCASTR (1972)	2414.011	CS MON IN WELL 18IN DN @ C/L INT AVE K + 5TH ST W MKD (22 27 T7N R12W)(N SIDE)	BL 83
LANCASTR (1972)	2405.296	L+BN @ NE COR OF SO CAL GAS CO VALVE BOX 44FT N C/L AVE K + 115FT W C/L 10TH ST W	BL 85
LANCASTR (1972)	2380.637	CS MON IN WELL @ C/L INT 10TH ST W + AVE J-8 MKD (1/4 COR 21 22 T7N R12W)(W EDGE)	BL 86
LANCASTR (1972)	2380.889	L+T 1FT N BCR @ NE COR 10TH ST W + AVE J-8 51FT N + 30FT E C/L INT	BL 87
LANCASTR (1972)	2377.128	L+T S CB AVE J-6 1FT E BCR @ SE COR 10TH ST W + AVE J-6 18FT S + 65FT E C/L INT	BL 88
LANCASTR (1972)	2362.909	CS MON IN WELL 8IN DN @ C/L INT OLDFIELD ST + DATE AVE	BL 91
LANCASTR (1972)	2363.186	L+T @ MCR NW COR OLDFIELD ST + DATE AVE 21FT N + 24FT W C/L INT	BL 92
LANCASTR (1972)	2397.395	USC+GS DISK IN CONC 6IN DN 60FT E + 125FT S C/L INT SIERRA HWY + AVE J-8 MKD (S 811 1947 RESET 1955)	BL 118
LANCASTR (1972)	2346.240	USC+GS BRASS DISK IN CONC 4IN UP 65FT E DR TO ANTELOPE VALLEY FAIR 681FT E OF C/L DIVISION ST + 41FT N C/L AVE I MKD (X 488 1955)	BL 119
LANCASTR (1972)	2324.666	L+T IN N SERVICE ROAD CB @ NE COR AVE I + 15TH ST W 51FT E + 80FT N C/L INT	BL 120
LANCASTR (1972)	2324.869	RDBM TAG IN S SERVICE ROAD CB @ SW COR AVE I + 15TH ST W 51FT W + 80FT S C/L INT	BL 121
LANCASTR (1972)	2322.192	CS MON 5IN UP @ NE COR AVE I + 20TH ST W 40FT N + 66FT E C/L INT MKD (BM 102-3 1957)	BL 122
LANCASTR (1972)	2342.247	CS MON IN WELL 12IN DN @ C/L INT AVE J + 20TH ST W MKD (SEC COR 17 16 20 21 R12W T7N) (N EDGE)	BL 126
LANCASTR (1972)	2344.120	RDBM TAG IN N CB @ NE COR AVE J + 20TH ST W 108FT E + 30FT N C/L INT	BL 127
LANCASTR (1972)	2349.709	RDBM TAG 6FT W BCR @ SW COR AVE J + 15TH ST W 66FT W + 30FT S C/L INT	BL 128
LANCASTR (1972)	2350.447	RDBM TAG 40FT S BCR @ SE COR AVE J + 15TH ST W 100FT S + 30FT E C/L INT	BL 129

QUAD-YEAR	ELEV	DESCRIPTION (INCLUDE QUAD AND YEAR IN DESCRIPTION)	BM NUMBER
LANCASTR (1972)	2338.807	L+BN 3FT W OF BCR @ SW COR LANCASTER BLVD + LOWTREE AVE 53FT W + 30FT S C/L INT	BL 131
LANCASTR (1972)	2336.305	L+BN 4FT N BCR @ NE COR LANCASTER BLVD + 15TH ST W 69FT N + 30FT E C/L INT	BL 132
BASELINE (1965)	2494.079	USC+GS DISK IN CONC POST 92FT N + 65FT W C/L INT AVE M + 40TH ST W MKD (F 489 1955)	BL 172
LANCASTR (1972)	2461.849	L+T NE COR CONC SLAB 100FT W + 66FT S C/L INT 50TH ST W + AVE L-8	BL 177
LANCASTR (1972)	2477.891	L+T CONC WLK IN FR OF CHURCH 45FT N + 65FT W C/L INT 50TH ST W + AVE L-12	BL 178
LANCASTR (1972)	2485.350	L+T CONC PORCH 50FT W + 45FT N C/L INT 50TH ST W + AVE L-14	BL 179
BASELINE (1965)	2495.234	L+T CONC SLAB NW COR PORCH TO HSE NO 42002 50TH ST W 48FT N + 66FT E C/L INT 50TH ST W + AVE M	BL 180A
LANCASTR (1972)	2411.788	2IN IRON PIPE 6IN UP 40FT W OF C/L 50TH ST W ON C/L AVE K-8	BL 183
LANCASTR (1972)	2410.110	CS MON (E EDGE) IN WELL 18IN DN @ C/L INT 50TH ST W + AVE K-8 MKD (1/4 COR 25 26 T7N R13W)	BL 184
LANCASTR (1972)	2380.020	CS MON (W EDGE) IN WELL 12IN DN @ C/L INT 50TH ST W + AVE K MKD (SEC COR 23 24 25 26 T7N R13W)	BL 185
LANCASTR (1972)	2382.262	L+T NW COR CONC PORCH HSE NO 4849 AVE K 115FT E + 120FT N C/L INT AVE K + 50TH ST W	BL 186
LANCASTR (1972)	2350.313	RDBM TAG S SIDE WIER BOX 97FT E + 85FT N C/L INT AVE J + 45TH ST W (TO THE N)	BL 191
LANCASTR (1972)	2343.680	ENG TAG + BRAD IN 2IN IP RP TO C/L INT IN HP @ SW COR AVE J + 40TH ST W 50FT S + 50FT W C/L INT	BL 194
LANCASTR (1972)	2343.732	CS MON IN WELL 8IN DN @ C/L INT AVE J + 40TH ST W MKD (T7N, R12W 13-18-19-24) USE N EDGE	BL 195
LANCASTR (1972)	2341.299	L+T CONC SLAB IN FRONT OF CHURCH @ NE COR AVE J + 35TH ST W 130FT N + 170FT E C/L INT MKD (BM)	BL 196
LANCASTR (1972)	2341.814	L+T IN SE COR CONC PORCH TO HSE NO 3129 W AVE J 75FT N C/L + 895FT W 30TH ST W	BL 198
LANCASTR (1972)	2341.663	PM IN DIAMOND ON NW QUAD SMH RIM ON C/L AVE J + 500FT W 30TH ST W 385FT E HSE 3129 + 90FT E RP 800770E	BL 199
LANCASTR (1972)	2338.462	CS MON (N EDGE) IN WELL 18IN DN @ C/L INT AVE J + 25TH ST W MKD (1/4 COR 17 20 T7N R12W)	BL 200
BASELINE (1965)	2496.435	CS MON IN WELL @ C/L INT AVE L+ 90TH ST E MKD (T7N R10W, SEC COR 29,30,31,32)	BL 254B
BASELINE (1965)	2473.301	CS MON 30IN DN @ C/L INT AVE K + 90TH ST E MKD (T7N R10W SEC 19 20 29 30) USE E EDGE	BL 263B
BASELINE (1965)	2454.169	CS MON 30IN DN @ C/L INT AVE J-8 + 90TH ST E MKD (R10W T7N 1/4 SEC 19 20)	BL 266B
BASELINE (1965)	2449.591	L+T N END 1ST STEP OF PORCH OF HSE NO 44207 90TH ST E 100FT W C/L + 1000FT S AVE J	BL 269B

QUAD-YEAR	ELEV	DESCRIPTION (INCLUDE QUAD AND YEAR IN DESCRIPTION)	BM NUMBER
BASELINE (1965)	2441.794	CS MON 15IN DN @ C/L INT 90TH ST E + AVE J MKD (T7N R10W SEC COR 18 17 19 20)	BL 271B
BASELINE (1965)	2431.384	L + T NR E EDGE CONC PORCH @ HSE NO 44709 90TH ST E 79FT W C/L + 600FT S AVE I-8 6FT N/D S END OF PORCH	BL 273B
BASELINE (1965)	2425.056	CS MON 20IN DN @ C/L INT 90TH ST E + AVE I-8 MKD (1/4 SEC 17 18 T7N R10W)	BL 274B
BASELINE (1965)	2412.568	CS MON 12IN DN @ C/L INT 90TH ST E + AVE I MKD (R10W T7N COR SEC 7,8,17,18)	BL 278B
LANCASTER (1972)	2400.324	CS MON IN CONC SQ 2IN UP 3FT S PP NO 991755E 39FT S C/L AVE I + 70FT W C/L 70TH ST E MKD (BM 107-30 1961)	BL 283
LANCASTER (1972)	2411.036	CS MON IN CONC SQ 2IN UP 1FT N TP NO K3143Y 30FT N C/L AVE I + 27FT W C/L PROP 85TH ST E MKD (BM 107-27 1961)	BL 284
LANCASTER (1972)	2413.264	CS MON 2FT S PP NO 991781E 30FT S C/L AVE I + 47FT W C/L 80TH ST E MKD (BM 107-28 1961)	BL 285
BASELINE (1965)	2392.783	LACS MON IN WELL 16IN DN @ C/L INT 90TH ST E + AVE H MKD SEC COR R10W T7N 5 6 7 8 USE NW EDGE	BL 286B
BASELINE (1965)	2394.247	RDBM TAG @ CTR OF OLD CONC BASE OF MTR MOUNT 40FT W C/L 90TH ST E + 100FT N C/L AVE H	BL 287B
LANCASTER (1972)	2409.311	LACS MON IN WELL 18IN DN @ C/L INT AVE I + 85TH ST E MKD SEC M-18 T7N R10W USE N EDGE	BL 288
LANCASTER (1972)	2410.801	RDBM TAG @ SE COR CONC FTG OF WATER TOWER @ HSE NO 8359 AVE I 60FT N + 20FT W C/L INT AVE I + 85TH ST E	BL 289
LANCASTER (1972)	2416.636	RDBM TAG TOP OF CONC SUPPORT OF LGE WATER TANK 90FT N C/L AVE I + 45FT W C/L 80TH ST E	BL 290
LANCASTER (1972)	2414.857	L+T @ SW COR OF CONC WLK TO HSE NO 7848 AVE I 200FT W C/L 80TH ST E + 80FT N C/L AVE I	BL 291
LANCASTER (1972)	2403.210	CSBM MON FLUSH 25FT S C/L AVE I + 25FT W C/L 75TH ST E 15FT W PP 482159E MKD (BM 107-29 1961)	BL 294
LANCASTER (1972)	2398.176	CS MON IN CONC 2IN UP 33FT S C/L AVE I + 142FT W C/L 65TH ST E 3FT S PP NO 1121124 MKD (BM 107- 31 1961)	BL 297
LANCASTER (1972)	2401.250	RDBM TAG TOP OF CONC WEIR BOX 35FT N C/L AVE I 400FT E OF 65TH ST E 50FT E OF DRWY TO HSE NO 6535 AVE I	BL 298
LANCASTER (1972)	2400.150	L+T E CB DRWY HSE NO 6007 AVE I 40FT N + 100FT E C/L INT E AVE I + 60TH ST E	BL 299
LANCASTER (1972)	2400.048	L+T W CB DRWY HSE NO 6007 AVE I 42FT N + 90FT E C/L INT E AVE I + 60TH ST E	BL 300
LANCASTER (1972)	2385.455	2IN IP 1FT ABOVE GROUND 40FT S OF C/L INT AVE I + 45TH ST E (USE E EDGE)	BL 305
LANCASTER (1972)	2383.610	L+T NE COR CONC WLK HSE NO 4010 AVE I 90FT S + 140FT E C/L INT AVE I + 40TH ST E	BL 307
LANCASTER (1972)	2381.794	L+T SE COR CONC SLAB @ NE COR BLDG NO 3606 AVE I 82FT S C/L + 150FT E C/L 36TH ST E	BL 309

QUAD-YEAR	ELEV	DESCRIPTION (INCLUDE QUAD AND YEAR IN DESCRIPTION)	BM NUMBER
LANCASTR (1972)	2379.852	CS MON IN CONC INT 21 FT S + 27 FT W C/L INT AVE I + 30TH ST MKD (D 489 1955)	BL 311
LANCASTR (1972)	2375.859	CS MON IN WELL @ C/L INT AVE I + 25TH ST E MKD (T7N, R11W, 1/4 COR 7-18) (E EDGE)	BL 313
LANCASTR (1972)	2373.509	USGS MON W/BR CAP 6IN UP 30FT S + 35FT E C/L INT 20TH ST E + AVE I MKD (LS 11 1929)	BL 315
LANCASTR (1972)	2372.769	L+T SE COR OF CONC APRON OF GAS STA 55FT N C/L AVE I + 65FT W C/L 20TH ST E	BL 316
LANCASTR (1972)	2353.400	L+T IN NW COR OF 4FT SQ CONC SLAB AT NW COR HSE NO 44126 20TH ST W 1700FT S OF AVE I 65FT E OF C/L 20TH ST W	BL 319
LANCASTR (1972)	2414.007	CS BR CAP MON 18IN DN @ C/L INT 20TH ST W + AVE K-8 MKD (1/4 COR SEC 29-28 T7N R12W)	BL 323
LANCASTR (1972)	2418.493	L+T IN CONC SLAB ON SE COR TO HSE NO 43111 20TH ST W 100FT W C/L + 260FT S C/L AVE L-8	BL 324
LANCASTR (1972)	2480.589	L+T IN CONC SLAB IN FRONT OF DOOR TO HSE 42423 20TH ST W 100FT W C/L + 250FT N C/L AVE L-8	BL 327
LANCASTR (1972)	2482.075	CS MON IN WELL 18IN DN @ C/L INT 20TH ST W + AVE L-8 MKD (SEC COR 28 29 32 33 T7N R12W)	BL 328
LANCASTR (1972)	2520.845	RDBM TAG IN NE COR 3FT SQ CONC BASE IN CONC PUMP 200FT N C/L AVE M + 125FT W C/L 20TH ST W	BL 329
BASELINE (1965)	2523.175	USC+GS BRASS DISK IN TOP OF CONC POST 4IN UP 208FT E OF C/L 20TH ST W + 33FT N C/L AVE M MKD (D 489 1955)	BL 330
LANCASTR (1972)	2391.531	CS MON IN WELL 18IN DN @ C/L INT 15TH ST W + AVE K MKD (1/4 SEC 21 28 T7N R12W)	BL 331
BASELINE (1965)	2518.134	CS MON IN WELL 18IN DN @ C/L INT AVE M + 25TH ST W MKD (1/4 COR 32 5 T6N R12W)	BL 334A
BASELINE (1965)	2523.287	L+T IN SE COR OF CONC DR TO HSE NO 2524 AVE M 140FT S C/L + 215FT W C/L 25TH ST W	BL 335
BASELINE (1965)	2520.165	USC+GS MON TOP OF CONC POST 4IN UP 300FT E C/L 30TH ST W + 34FT N C/L AVE M 6FT W PP NO 1054594E MKD (E 489 1955)	BL 336
BASELINE (1965)	2514.874	CS MON IN WELL @ C/L INT AVE M + 30TH ST W MKD (SEC COR 31 32 5 6 T7N T6N R12W)	BL 337A
LANCASTR (1972)	2448.706	CS MON 24IN DN @ C/L INT OF AVE L + 25TH ST W MKD (1/4 SEC COR 29 32 T7N R12W)	BL 382
LANCASTR (1972)	2448.903	L+T IN BOTTOM STEP @ W EDGE OF CONC STEPS TO HSE NO 2507 AVE L 73FT N C/L + 78FT W C/L 25TH ST W	BL 383
LANCASTR (1972)	2441.190	CS MON 18IN DN @ C/L INT OF AVE L + 30TH ST W MKD (SEC COR 29 30 31 32 T7N R12W)	BL 384
LANCASTR (1972)	2441.234	L+T NE COR CONC DR TO HSE NO 3018 AVE L 75FT S C/L + 195FT W C/L 30TH ST W	BL 385
LANCASTR (1972)	2434.956	L+T NW COR CONC SLAB TO HSE NO 3550 AVE L 65FT S C/L + 139FT E C/L 35TH ST W	BL 386
LANCASTR (1972)	2433.345	CS MON 6IN DN @ C/L INT AVE L + 35TH ST W MKD (1/4 COR SEC 30 31 T7N R12W) (S EDGE)	BL 387

QUAD-YEAR	ELEV	DESCRIPTION (INCLUDE QUAD AND YEAR IN DESCRIPTION)	BM NUMBER
LANCASTR (1972)	2428.373	CS MON 8IN DN @ C/L INT OF AVE L + 40TH ST W MKD (T7N R12W R13W SEC COR 25 30 36 31)(SE EDGE)	BL 388
LANCASTR (1972)	2431.875	L+T IN W EDGE OF 2FT CONC WLK TO APT NO 4012 AVE L 50FT S C/L + 110FT W C/L 40TH ST W	BL 389
LANCASTR (1972)	2428.403	USGS MON @ NW COR AVE L + 45TH ST W 38FT N + 37FT W C/L INT MKD (R 49 1929 RESET 1942)	BL 391
LANCASTR (1972)	2432.354	L+T IN CONC PORCH OF HSE ON NW COR 50TH ST W + AVE L 109FT N + 232FT W C/L INT MKD OUT	BL 392
BASELINE (1965)	2491.236	CS MON IN WELL 14IN DN @ C/L INT AVE M + 50TH ST W MKD (SEC COR 35 36 2 1 T7N T6N R13W) (W EDGE)	BL 394B
BASELINE (1965)	2496.566	CS MON IN WELL 15IN DN @ C/L INT OF AVE M + 55TH ST W MKD (1/4 COR SEC 35, 2 R-13W T-7N T-6N) USE S EDGE	BL 395
BASELINE (1965)	2500.800	L+T IN CONC WLK TO HSE ON AVE M + 55TH ST W MKD (1/4 COR SEC 35, 2 R-13W T-7N T-6N) USE S EDGE DISTURBED	BL 396
BASELINE (1965)	2513.834	CS MON IN WELL 22IN DN @ C/L INT OF AVE M + 60TH ST W MKD (SEC COR 34 35 3 2 T7N T6N R13W)	BL 397
LANCASTR (1972)	2382.937	CS MON IN WELL 18IN DN @ C/L INT 60TH ST E + AVE H-8 PROP MKD (1/4 SEC COR 11 10 R11W T7N) (S EDGE)	BL 411
LANCASTR (1972)	2385.967	RDBM TAG IN SE COR CONC RESERVOIR @ HSE NO 45609 60TH ST E 110FT W C/L + 55FT N C/L AVE H-8 PROP	BL 412
LANCASTR (1972)	2370.369	CS MON IN WELL 18IN DN @ C/L INT 60TH ST E + AVE H MKD (SEC COR 3 2 10 11 R11W T7N)(S EDGE)	BL 413
LANCASTR (1972)	2360.728	CS MON 18IN DN @ C/L INT 60TH ST E + AVE G-8 MKD (1/4 SEC COR 3 2 R11W T7N)(N EDGE)	BL 415
LANCASTR (1972)	2362.047	L+T NR S EDGE OF CONC WK TO HSE NO 46415 60TH ST E 130FT W C/L + 145FT N C/L AVE G-8 MKD (SLBM)	BL 416
LANCASTR (1972)	2352.376	LACS MON IN WELL 16IN DN @ C/L INT 60TH ST E + AVE G MKD SEC COR 34 35 3 2 T7N R11W USE SW EDG CS MON 16IN DN @ C/L INT 60TH ST E + AVE G MKD (SEC COR 34 35 3 2 R11W T8N)	BL 417
LANCASTR (1972)	2345.740	L+T IN CONC FENCE POST @ SE COR 60TH ST E + AVE F-8 20FT S + 22FT E C/L INT MKD (SLBM)	BL 419
LANCASTR (1972)	2344.152	LACS MON IN WELL 24IN DN @ C/L INT 60TH ST E + AVE F-8 MKD 1/4 COR 34 35 T7N R11W USE W EDGE CS MON @ C/L INT 60TH ST E + AVE F-8 MKD (1/4 SEC COR 34 35 R11W T8N)(W EDGE)	BL 420
LANCASTR (1972)	2336.872	RD MON 8IN DN @ SW COR AVE F + 60TH ST E 47FT W + 25FT S C/L INT	BL 422
LANCASTR (1972)	2339.155	RD MON IN WELL WITH COVER @ NE COR 65TH ST E + AVE F 24FT N + 42FT E C/L INT 4FT E GUY POLE NO 627428E	BL 424
LANCASTR (1972)	2343.353	RD MON IN WELL W/COVER 8IN DN @ NW COR AVE F + 70TH ST E 34FT N + 25FT W C/L INT 4FT N OF PP NO 373290E	BL 425
LANCASTR (1972)	2343.797	CS MON 8IN DN @ C/L INT AVE F + 70TH ST E MKD (SEC COR 26 25 35 36 R11W T8N)(N EDGE)	BL 426

QUAD-YEAR	ELEV	DESCRIPTION (INCLUDE QUAD AND YEAR IN DESCRIPTION)	BM NUMBER
LANCASTR (1972)	2347.757	L+BN IN CONC FTG OF 36IN STANDPIPE 40FT N C/L AVE F + 31FT W C/L 75TH ST E PROP MKD (SLBM)	BL 427
LANCASTR (1972)	2346.326	CS MON 12IN DN @ C/L INT AVE F + 75TH ST E MKD (1/4 SEC COR 25 36 R11W T8N)(N EDGE)	BL 428
LANCASTR (1972)	2348.987	CS MON @ C/L INT AVE F + 80TH ST E MKD (SEC COR 25 30 36 31 R10W R11W T8N)(E EDGE)	BL 430
BASELINE (1965)	2354.853	L+T CONC FOUNDATION OF WATER TOWER 6FT W + 1.5FT N OF SE COR @ NW COR 90TH ST E + AVE F 45FT N + 95FT W C/L INT MKD (SLBM)	BL 433B
BASELINE (1965)	2354.502	CS MON 12IN DN @ C/L INT 90TH ST E + AVE F MKD (SEC COR 30 29 31 32 R10W T8N)(E EDGE)	BL 434B
BASELINE (1965)	2365.094	2IN IP WITH CONC PLUG + BT SPK @ C/L INT 90TH ST E + AVE F-8	BL 436B
BASELINE (1965)	2372.935	CS MON IN WELL 15IN DN @ C/L INT 90TH ST E + AVE G MKD (SEC COR 31 32 6 5 R10W T8N T7N)	BL 437B
BASELINE (1965)	2374.275	RD MON IN WELL WITH CONC COLLAR @ SE COR 90TH ST E + AVE G 30FT E + 40FT S C/L INT	BL 438B
BASELINE (1965)	2385.018	2IN IP IN CONC WITH BR CAP ON C/L AVE G-8 30FT W C/L 90TH ST E MKD (WC SEC 6 R10W T7N)	BL 439B
LANCASTR (1972)	2497.847	USC+GS MON 3IN UP 60FT E C/L SIERRA HWY OPP BLDG NO 42445 2200FT S AVE L MKD U 811 1947	BL 470
LANCASTR (1972)	2486.633	USC+GS MON 12IN DN 60FT E C/L SIERRA HWY OPP BLDG NO 42607 1250FT S AVE L MKD B 57 1926 RESET 1955	BL 471
LANCASTR (1972)	2447.454	USC+GS MON 3IN UP 59FT E C/L SIERRA HWY + 75FT N C/L PROP AVE K-8 MKD T 811 1947	BL 472
LANCASTR (1972)	2332.743	USGS MON ON 3IN IP 2IN UP IN REAR OF A V PLUMBIN SUPPLY @ NO 45358 SIERRA HWY 161FT E/O C/L + 1100FT N AVE I MKD 2335 B 1902	BL 474
LANCASTR (1972)	2317.405	USC+GS MON S EDGE HDWL CULV G90+50 25FT W C/L SIERRA HWY + 0.4MI S AVE G MKD (Z 811 1947)	BL 476
LANCASTR (1972)	2305.363	USC+GS MON 10IN UP 34FT E C/L SIERRA HWY + 1450FT S AVE F MKD (Y 56 1926)	BL 477
LANCASTR (1972)	2302.182	USGS MON ON 3IN IP 8IN UP 85FT E C/L SIERRA HWY + 800FT N AVE F MKD (2302 B 1902 33)	BL 478
LANCASTR (1972)	2304.315	USGS TRI STA MON 15IN UP 227FT W C/L SIERRA HWY + 2200FT N AVE F MKD (OBAN 1929 LINT)	BL 479
LANCASTR (1972)	2301.558	USC+GS REF MON 8IN UP 227FT W C/L SIERRA HWY + 2280FT N AVE F MKD (OBAN NO 2 1941)	BL 480
LANCASTR (1972)	2300.920	USC+GS MON FLUSH W END S CONC ABUT OF RR BRIDGE 73FT N C/L AVE E + 121FT E C/L SIERRA HWY MKD (H 487 1955)	BL 481
LANCASTR (1972)	2303.946	USC+GS MON FLUSH TOP OF E END OF S CONC ABUT OF SPRR BRIDGE 88FT N C/L AVE C + 141FT E C/L SIERRA HWY MKD (J 487 1955)	BL 482
LANCASTR (1972)	2305.757	USC+GS MON FLUSH S END W HDWL CULV UNDER SPRR 35FT N C/L AVE B + 122FT E C/L SIERRA HWY MKD (N 487 1955)	BL 483

QUAD-YEAR	ELEV	DESCRIPTION (INCLUDE QUAD AND YEAR IN DESCRIPTION)	BM NUMBER
LANCASTR (1972)	2307.921	USC+GS MON FLUSH N END HDWL OF SPRR CULV 123FT E C/L SIERRA HWY + 175FT S C/L AVE A (KERN CO LINE) MKD (M 487 1955)	BL 484
LANCASTR (1972)	2334.119	RDBM TAG E CB 60FT S BCR @ SE COR DIVISION ST + AVE H-8 20FT E + 135FT S C/L INT	BL 485
LANCASTR (1972)	2332.340	CS MON (N EDGE) IN WELL 18IN DN @ C/L INT AVE H-8 + DIVISION ST MKD (1/4 SEC COR 10 11 T7N R12W)	BL 487
LANCASTR (1972)	2333.361	CS MON 12IN DN @ C/L INT DIVISION ST + AVE H MKD (SEC COR 3-2 10-11 T7N R12W) USE W EDGE	BL 488
LANCASTR (1972)	2327.784	L+T NW COR CONC WALK BLDG NO 46350 @ SE COR OF DIVISION ST + AVE G8 (PROP) 205FT S + 45FT E OF C/L INT	BL 490
LANCASTR (1972)	2325.775	CS BR CAP MON 24IN DN @ C/L INT OF AVE G8 PROP + DIVISION ST MKD (1/4 SEC COR 2-3 T7N R12W)	BL 491
LANCASTR (1972)	2322.818	2IN IP WITH CONC PLUG 12IN UP @ SE COR DIVISION ST + AVE G ³⁵ / ₂₂ FT S + ³⁵ / ₂₂ FT E OF C/L INT (E EDGE)	BL 492
LANCASTR (1972)	2320.702	CS BR CAP MON IN WELL 15IN DN @ C/L INT DIVISION ST + AVE G MKD (SEC COR 34-35-3-2 T8N T7N R12W)	BL 493
LANCASTR (1972)	2315.257	L+T @ NE COR CONC SLAB @ SIDE ENT N SIDE OF HSE NO 47159 DIVISION ST 100FT W C/L + 80FT S C/L AVE F-8	BL 494
LANCASTR (1972)	2306.535	CS MON 14IN DN @ C/L INT OF AVE F + DIVISION ST MKD (SEC COR 26-27 34-35 R12W T8N)(E EDGE)	BL 497
LANCASTR (1972)	2301.132	CS BR CAP MON 14IN DN @ C/L INT AVE E-8 + DIVISION ST MKD (26-27 R12W T8N)	BL 498
LANCASTR (1972)	2295.723	RD DEPT BM MON IN WELL 6IN DN @ SW COR DIVISION ST + AVE E 27FT W + 51FT S C/L INT 4 FT WLY PP NO 306431E	BL 499
LANCASTR (1972)	2294.181	CS MON (NE EDGE) IN WELL 31IN DN @ C/L INT AVE E + DIVISION ST MKD (SEC COR 22 23 26 27 T8N)	BL 500
LANCASTR (1972)	2296.009	CS MON 18IN DN ON C/L AVE E 2677FT W OF DIVISION ST MKD (T8N 22-27 R12W 1/4 COR)(N EDGE)	BL 501
LANCASTR (1972)	2348.816	RDBM TAG CONC SLAB NR 36IN STANDPIPE 40FT N C/L AVE J + 640FT E 50TH ST W	BL 532
LANCASTR (1972)	2348.120	CS MON IN WELL 20IN DN @ C/L INT AVE J + 50TH ST W MKD (SEC COR 14 13 23 24 T7N R13W)	BL 533
LANCASTR (1972)	2337.875	2IN IP 6IN DN 50FT S + 50FT E C/L INT 50TH ST W + AVE I-8	BL 534
LANCASTR (1972)	2337.824	2IN IP 6IN DN 50FT N + 50FT E C/L INT 50TH ST W + AVE I-8	BL 535
LANCASTR (1972)	2329.742	CS MON IN TOP 12IN CONC POST 5IN UP 89FT N C/L AVE I + 30FT E C/L 45TH ST W MKD (BM 102-9 1957)	BL 537
LANCASTR (1972)	2328.018	US GS MON 12IN UP 36FT W C/L 40TH ST W + 147FT S C/L AVE I 33FT E OFFE SIDE HSE 4011 MKD LINT ALKALI 1929	BL 538
LANCASTR (1972)	2317.995	CS MON TOP 12IN CONC POST 6IN UP 42FT N C/L AVE I + 63FT E C/L 35TH ST W 39FT E OF DRWY HSE 3355 + 25FT W PP 865024E MKD (BM 102-7 1957)	BL 539

QUAD-YEAR	ELEV	DESCRIPTION (INCLUDE QUAD AND YEAR IN DESCRIPTION)	BM NUMBER
LANCASTR (1972)	2317.733	L+PK TOP NW COR N HDWL OF BRIDGE NO 53-406 22FT N C/L AVE I + 100FT E C/L 30TH ST W	BL 540
LANCASTR (1972)	2317.142	CS MON TOP CONC POST 4IN UP 86FT N C/L AVE I + 2FT W C/L 25TH ST W 4FT S PP 1162700E MKD (BM 102-5 1957)	BL 542
LANCASTR (1972)	2368.678	CS MON 12IN DN @ C/L INT 30TH ST E + AVE H-8 MKD (1/4 COR 7-8 T7N R11W)(E EDGE)	BL 554
LANCASTR (1972)	2361.641	2IN IP 50FT E C/L 30TH ST E + 50FT S OUT USE SW RIM	BL 555
LANCASTR (1972)	2359.294	CS MON 6IN DN @ C/L INT 30TH ST E + AVE H MKD (SEC COR 5-6-7-8 T7N R11W) USE S EDGE	BL 556
LANCASTR (1972)	2353.225	2IN IP 50FT E C/L 30TH ST E + 50FT S C/L AVE G-8 USE SE RIM	BL 557
LANCASTR (1972)	2350.265	CS MON 8IN DN @ C/L INT 30TH ST E + AVE G-8 MKD (1/4 SEC COR 6-7 T7N R11W) USE S EDGE	BL 558
LANCASTR (1972)	2344.376	2IN IP 50FT E C/L 30TH ST E + 50FT S C/L AVE G USE S EDGE	BL 559
LANCASTR (1972)	2343.436	CS MON 3IN DN @ C/L INT 30TH ST E + AVE G MKD (31-32-5-6 T7N R11W) USE SW EDGE	BL 560
LANCASTR (1972)	2335.174	CS MON 12IN DN @ C/L INT 30TH ST E + AVE F-8 MKD (1/4 COR 31-32 T8N R11W)(S EDGE)	BL 561
LANCASTR (1972)	2336.505	2IN IP 50FT E C/L 30TH ST E + 50FT N C/L AVE F-8 USE NE RIM	BL 562
LANCASTR (1972)	2328.814	2IN IP 50FT E C/L 30TH ST E + 50FT S C/L AVE F	BL 563
LANCASTR (1972)	2327.468	CS MON 15IN DN @ C/L INT 30TH ST E + AVE F MKD (29-30-31-32 T8N R11W) USE E EDGE	BL 564
LANCASTR (1972)	2319.138	CS MON (E EDGE) IN WELL 15IN DN @ C/L INT 30TH ST E + AVE E-8 MKD (1/4 COR 29 30 T8N R11W)	BL 566
LANCASTR (1972)	2296.931	RD MON IN WELL 8IN DN 5FT S PP NO 1270585E 36FT S C/L AVE E + 240FT W C/L 5TH ST E PROP	BL 567
LANCASTR (1972)	2297.061	CS MON (E EDGE) IN WELL @ C/L INT AVE E + PROP 5TH ST E MKD (1/4 COR 23 26 T8N R12W)	BL 568
LANCASTR (1972)	2300.681	CS MON (N EDGE) IN WELL 18IN DN @ C/L INT AVE E + 10TH ST E PROP MKD (SEC COR 23 24 25 26 T8N R12W)	BL 569
LANCASTR (1972)	2302.365	RD MON IN WELL 8IN DN 6FT S PP NO 1270596E 36FT S C/L AVE E 70FT E C/L 10TH ST E (PROPOSED)	BL 570
LANCASTR (1972)	2303.276	RD MON IN WELL 8IN DN 5FT S PP NO 1270605E 40FT S C/L AVE E 240FT W C/L 15TH ST E (PROPOSED)	BL 571
LANCASTR (1972)	2302.877	CS MON 30IN DN @ C/L INT AVE E + 15TH ST E MKD (1/4 COR 24-25 T8N R12W)(W EDGE)	BL 572
LANCASTR (1972)	2310.640	RD MON IN WELL 8IN DN 6FT S PP NO 1270627E 39FT S C/L AVE E + 225FT E C/L 25TH ST E PROP	BL 576
LANCASTR (1972)	2312.073	2IN IP 50FT E C/L 30TH ST E + 50FT S C/L AVE E USE N RIM	BL 577

QUAD-YEAR	ELEV	DESCRIPTION (INCLUDE QUAD AND YEAR IN DESCRIPTION)	BM NUMBER
LANCASTR (1972)	2313.640	RD MON IN WELL 8IN DN 5FT S PP NO 1270648E 28FT S C/L AVE E 260FT W C/L 35TH ST E (PROPOSED)	BL 579
LANCASTR (1972)	2312.874	CS MON (N EDGE) IN WELL 22IN DN @ C/L INT AVE E + 35TH ST E MKD (1/4 SEC COR 20 29 T8N R11W)	BL 580
LANCASTR (1972)	2316.038	RD MON IN WELL 8IN DN 5FT S PP NO 1273708E 30FT S C/L AVE E + 250FT W C/L 40TH ST E (PROPOSED)	BL 581
LANCASTR (1972)	2314.654	CS MON IN WELL 18IN DN @ C/L INT AVE E + 45TH ST E (PROPOSED) MKD (1/4 COR 21-28 T8N R11W) USE N EDGE	BL 583
LANCASTR (1972)	2317.158	CS MON IN WELL 8IN DN @ C/L INT AVE E + 50TH ST E MKD (SEC COR 21-22-27-28 T8N R11W) USE N EDGE	BL 585
LANCASTR (1972)	2321.346	CS MON IN WELL 8IN DN @ C/L INT AVE E + 55TH ST E MKD (1/4 COR 22 27 R11W T8N)(N EDGE)	BL 587
LANCASTR (1972)	2322.529	L+T IN CONC STANDPIPE 33FT N C/L AVE E C/L 55TH ST E MKD (BM) OUT	BL 588
LANCASTR (1972)	2322.065	CS MON IN WELL 8IN DN @ C/L INT AVE E + 60TH ST E MKD (SEC COR 22-23-26-27 T8N R11W) USE N EDGE	BL 589
LANCASTR (1972)	2322.366	L+T IN CONC SLAB OF GARAGE TO HSE ON NW COR AVE E + 60TH ST E 65FT W + 145FT N (BM) OUT	BL 590
LANCASTR (1972)	2329.022	CS MON (E EDGE) IN WELL 18IN DN @ C/L INT 60TH ST E + PROP AVE E-8 MKD (1/4 COR 27 26 T8N R11W)	BL 591
LANCASTR (1972)	2330.054	L+T CONC PUMP BASE 35FT N C/L AVE E-8 + 170FT E C/L 60TH ST E MKD (BM)	BL 592
LANCASTR (1972)	2338.615	L+T 4FT E BCR 38FT N C/L AVE I 50FT E C/L SIERRA HWY	BL 666
LANCASTR (1972)	2337.723	CSBM MON 64FT N C/L AVE I + 168FT E C/L SIERRA HWY MKD (BM 101-132 1957)	BL 667
LANCASTR (1972)	2341.197	L+T 5FT E OF W END CONC PUMP ISL 50FT E C/L TREVOR AVE 60FT S C/L AVE I	BL 668
LANCASTR (1972)	2340.880	L+T N CB (DEP) 24FT E C/L SPEARMAN AVE + 40FT N C/L AVE I	BL 669
LANCASTR (1972)	2351.700	RDBM TAG E CB 49FT N BCR @ NE COR SIERRA HWY + LANCASTER BLVD 116FT N + 30FT E C/L INT	BL 670
LANCASTR (1972)	2356.047	L+T 10FT W BCR @ NW COR DIVISION ST + LANCASTER BLVD FROM W 30FT N + 44FT W C/L INT	BL 671
LANCASTR (1972)	2359.612	USC+GS MON FL 150FT N C/L NEWGROVE ST + 175FT E C/L SIERRA HWY MKD A 57 1926	BL 672
LANCASTR (1972)	2357.586	L+T CTR CB RET @ SE COR MILLING ST + YUCCA AVE 39FT S + 46FT E C/L INT	BL 673
LANCASTR (1972)	2364.225	L+BRAD S CB 1FT W BCR 30FT S C/L LANCASTER BLVD 43FT W C/L 3RD ST E	BL 675
LANCASTR (1972)	2364.615	L+BRAD E CB 0.5FT S BCR 18FT E C/L 3RD ST E 54FT S C/L LANCASTER BLVD	BL 676
LANCASTR (1972)	2370.547	L+T S CB 3FT E BCR 30FT S C/L LANCASTER BLVD 51FT W C/L 5TH ST E	BL 677

QUAD-YEAR	ELEV	DESCRIPTION (INCLUDE QUAD AND YEAR IN DESCRIPTION)	BM NUMBER
LANCASTR (1972)	2371.417	L+T E CB 2FT S BCR 30FT E C/L 5TH ST E 63FT S C/L LANCASTER BLVD	BL 678
LANCASTR (1972)	2373.305	L+T S CB SERVICE RD 0.5 FT W BCR 70FT S C/L LANCASTER BLVD 50FT W C/L ANDALE AVE	BL 679
LANCASTR (1972)	2378.933	CSBM MON FLUSH 50FT S C/L AVE J + 174FT E C/L SIERRA HWY MKD (BM 101-128 1957)	BL 680
LANCASTR (1972)	2350.362	CS MON 27IN DN @ C/L INT AVE J + 55TH ST W (PROP) MKD (1/4 COR 14-23 R13W T7N)	BL 704
LANCASTR (1972)	2352.643	RD MON IN WELL 8IN DN ON SW COR AVE J + 55TH ST W (PROP) 100FT W + 50FT S C/L INT 2IN IP MARKER 2FT S 3FT UP	BL 705
LANCASTR (1972)	2353.465	CS MON IN WELL 18IN DN @ C/L INT AVE J + 60TH ST W MKD (SEC COR 14-15-22-23 T7N R13W)	BL 706
LANCASTR (1972)	2355.012	RDBM TAG IN COR OF FENCE ON NE COR AVE J + 60TH ST W 33FT N + 43FT E C/L INT	BL 707
LANCASTR (1972)	2347.816	CS MON IN WELL 10IN DN @ C/L INT 60TH ST W + AVE I-8 (PROP) MKD (1/4 COR 14-15 T7N R13W)	BL 708
LANCASTR (1972)	2346.387	RD MON IN WELL 8IN DN ON NW COR 60TH ST W + AVE I-8 (PROP) 95FT N + 50FT W C/L INT 2IN IP MARKER 2FT W 3FT UP	BL 709
LANCASTR (1972)	2348.870	USC+GS BR CAP IN CONC FLOOR OF GUARD HSE OF MIRA LOMA @ SE COR AVE I + 60TH ST W 125FT S + 100FT E C/L INT MKD (U 1153 1961)	BL 710
LANCASTR (1972)	2335.424	USC+GS BR CAP NR COR CONC HDWL @ SW COR AVE I + 50TH ST W 30FT S + 31FT W C/L INT MKD (T 1153 1961)	BL 712
LANCASTR (1972)	2342.285	RDBM TAG ON CONC COLLAR OF SMH (S SIDE) 46FT N C/L AVE I + 9FT E C/L 55TH ST W (PROP)	BL 713
LANCASTR (1972)	2334.130	RDBM TAG IN CONC FTG OF COR FENCE POST ON SW COR 50TH ST W + AVE I 40FT S + 60FT W C/L INT	BL 714
LANCASTR (1972)	2335.410	RDBM TAG IN CONC HDWL BETWEEN 2 CMP ON SW COR 50TH ST W + AVE I 35FT S + 26FT W C/L INT	BL 715
LANCASTR (1972)	2329.741	RDBM TAG ON CONC COLLAR OF SMH RIM NE COR AVE I + 45TH ST W 28FT N + 5FT E C/L INT	BL 716
LANCASTR (1972)	2319.618	L+T IN CONC PORCH OF HSE @ NE COR AVE I + 55TH ST W 125FT N + 100FT E C/L INT MKD (BM 105-4 1958)	BL 718
LANCASTR (1972)	2387.938	CS MON FLUSH ON SW COR AVE K + 20TH ST W 39FT S + 39FT W C/L INT MKD (BM 105-4 1958)	BL 719
LANCASTR (1972)	2388.206	L+T CONC DR NR CONC BLOCK POST 42FT S C/L AVE K + 263FT W C/L 25TH ST W MKD (BM)	BL 721
LANCASTR (1972)	2386.247	CS MON IN WELL 20IN DN @ C/L INT AVE K + 30TH ST W MKD (SEC COR 19-20-29-30 R12W T7N) USE N EDGE	BL 722
LANCASTR (1972)	2385.604	RD MON IN WELL 8IN DN ON SE COR AVE K + 35TH ST W 100FT E + 50FT S C/L INT	BL 724
LANCASTR (1972)	2383.428	CS MON IN WELL 20IN DN @ C/L INT AVE K + 35TH ST W MKD (1/4 COR 19-30 R12W T7N) USE S EDGE	BL 725

QUAD-YEAR	ELEV	DESCRIPTION (INCLUDE QUAD AND YEAR IN DESCRIPTION)	BM NUMBER
LANCASTR (1972)	2382.560	CS MON IN WELL 6IN DN @ C/L INT AVE K + 40TH ST W MKD (SEC COR 19-24-25-30 R12W T7N)(W EDGE)	BL 726
LANCASTR (1972)	2360.206	RD MON IN WELL 8IN DN ON SE COR 30TH ST W + AVE J-8 100FT S + 50FT E C/L INT	BL 729
LANCASTR (1972)	2414.766	RDBM MON IN WELL 8IN DN ON SE COR 30TH ST W + AVE K-8 92FT S + 50FT E C/L INT OUT	BL 731
LANCASTR (1972)	2360.257	USC+GS MON FLUSH ON NW COR AVE I + 66TH ST W 228FT W + 25FT N C/L INT MKD (H 747 1945)	BL 819
LANCASTR (1972)	2364.796	CSBM MON FLUSH ON NW COR AVE I + 70TH ST W 30FT N + 22FT W C/L INT MKD (BM 102-15 1957)	BL 820
LANCASTR (1972)	2365.371	L+T CONC SLAB OF BLDG ON SW COR AVE I + 70TH ST W 114FT W + 70FT S C/L INT MKD (BM)	BL 821
LANCASTR (1972)	2374.288	L+T W END GAS ISL ON SE COR AVE I + 75TH ST W 115FT E + 90FT S C/L INT MKD (BM)	BL 822
LANCASTR (1972)	2376.175	USC+GS MON FLUSH NE COR AVE I + 75TH ST W 61FT N + 16FT E C/L INT MKD (B 306 1935)	BL 823
LANCASTR (1972)	2390.458	L+T CONC STANDPIPE SE COR AVE I + 80TH ST W 60FT S + 60FT E C/L INT MKD (BM)	BL 824
LANCASTR (1972)	2389.089	CS MON FLUSH NW COR AVE I + 80TH ST W 48FT N + 25FT W C/L INT MKD (BM 102-17 1957)	BL 825
LANCASTR (1972)	2403.620	RDBM TAG IN NE COR CONC WEIR BOX SE COR AVE I + PROP 85TH ST W 32FT S + 25FT E C/L INT	BL 826
LANCASTR (1972)	2399.727	CS MON FLUSH 28FT N C/L AVE I + 7FT E C/L PROP 85TH ST W MKD (BM 102-18 1957)	BL 827
LANCASTR (1972)	2420.053	L+T CONC WK HSE SE COR AVE I + 90TH ST W 83FT S + 60FT E C/L INT MKD (BM)	BL 828
LANCASTR (1972)	2421.628	CS MON NW COR AVE I + 90TH ST W 31FT N + 70FT W C/L INT MKD (BM 102-19 1957)	BL 829
LANCASTR (1972)	2417.581	RDBM MON IN WELL 8IN DN SE COR 90TH ST W + PROP AVE H-8 75FT S + 25FT E C/L INT 2IN IP MARKER 2FT E 3FT UP	BL 830
LANCASTR (1972)	2422.759	L+T IN 24IN CONC STANDPIPE @ SE COR 90TH ST W + PROP AVE H-8 180FT E + 30FT S C/L INT MKD (BM)	BL 831
LANCASTR (1972)	2430.104	RDBM TAG N CB PARKING AREA NW COR 90TH ST W + AVE H 155FT W + 44FT N C/L INT	BL 832
LANCASTR (1972)	2430.514	RDBM TAG W CB PARKING AREA NW COR 90TH ST W + AVE H 250FT N + 50FT W C/L INT	BL 833
LANCASTR (1972)	2428.614	RDBM TAG CONC BASE OF 3IN IP BREATHER SE COR 90TH ST W + PROP AVE G-8 50FT S + 40FT E C/L INT	BL 834
LANCASTR (1972)	2429.853	RDBM MON IN WELL 8IN DN ON NW COR 90TH ST W + PROP AVE G-8 210FT N + 23FT W C/L INT 6FT S PP K5409Y 2IN IP MKR 3FT UP 2FT W	BL 835
LANCASTR (1972)	2424.638	CS MON IN WELL 14IN DN @ C/L INT 90TH ST W + AVE G MKD (SEC COR 31 32 5 6 T8N T7N R13W)	BL 836
LANCASTR (1972)	2416.541	L+T IN CONC WK OF HSE SW COR 90TH ST W + AVE F 380FT S + 85FT W C/L INT MKD (BM)	BL 838

QUAD-YEAR	ELEV	DESCRIPTION (INCLUDE QUAD AND YEAR IN DESCRIPTION)	BM NUMBER
LANCASTR (1972)	2416.633	CS MON 18IN DN @ C/L INT 90TH ST W + AVE F MKD (SEC COR 29 30 31 32 T8N R13W)	BL 839
LANCASTR (1972)	2422.594	CS MON 14IN DN @ C/L INT 90TH ST W + AVE E-8 MKD (T8N R13W 29-30)	BL 840
LANCASTR (1972)	2424.285	L+T IN CONC PORCH STORE BLDG NW COR 90TH ST W + AVE E-8 100FT N + 80FT W C/L INT MKD (BM)	BL 841
LANCASTR (1972)	2433.373	L+T CONC PORCH HSE SW COR 90TH ST W + AVE E 68FT S + 92FT W C/L INT MKD (BM)	BL 843
LANCASTR (1972)	2437.395	CS MON 18IN DN @ C/L INT 90TH ST W + AVE D MKD (SEC COR 17 18 19 20 T8N R13W)	BL 846
LANCASTR (1972)	2440.719	RDBM TAG IN CONC FTG OF 10IN BREATHER NE COR PUMP HSE SE COR 90TH ST W + AVE D 150FT E + 56FT S C/L INT	BL 847
LANCASTR (1972)	2440.345	CS MON 12IN DN @ C/L INT 90TH ST W + PROP AVE B-8 MKD (T8N R13W 7-8)	BL 852
LANCASTR (1972)	2445.198	RDBM TAG CONC STANDPIPE 30IN UP NW COR 90TH ST W + PROP AVE B-8 30FT N + 55FT W C/L INT	BL 853
LANCASTR (1972)	2438.165	CS MON IN WELL 8IN DN @ C/L INT 90TH ST W + AVE B MKD (5 6 7 8 T8N R13W)	BL 855
LANCASTR (1972)	2428.112	RDBM MON IN WELL 8IN DN SE COR AVE B + 85TH ST W 167FT E + 35FT S C/L INT 2IN IP MARKER 2FT S 3FT UP	BL 857
LANCASTR (1972)	2416.230	CS MON 14IN DN @ C/L INT AVE B + 80TH ST W MKD (SEC COR 4 5 8 9 T8N R13W)	BL 858
LANCASTR (1972)	2416.497	RDBM MON IN WELL 8IN DN @ NE COR AVE B + 80TH ST W 30FT N + 72FT E C/L INT 2IN IP MKR 3FT UP 2FT N	BL 859
LANCASTR (1972)	2407.804	RDBM MON IN WELL 8IN DN NE COR AVE B + PROP 75TH ST W 28FT N + 42FT E C/L INT 2IN IP MARKER 2FT N 3FT UP	BL 861
LANCASTR (1972)	2395.591	CS MON 14IN DN @ C/L INT AVE B + 70TH ST W MKD (T8N R13W 3-4-9-10)	BL 862
LANCASTR (1972)	2396.872	RDBM MON IN WELL 8IN DN NE COR AVE B + 70TH ST W 25FT N + 65FT E C/L INT 2IN IP MARKER 2FT N 3FT UP	BL 863
LANCASTR (1972)	2388.409	RDBM MON IN WELL 8IN DN NE COR AVE B + 65TH ST W 33FT N + 96FT E C/L INT 2IN IP MARKER 2FT N 3FT UP	BL 865
LANCASTR (1972)	2380.594	CS MON 14IN DN @ C/L INT AVE B + 60TH ST W MKD (T8N R13W 2-3-10-11)	BL 866
LANCASTR (1972)	2381.168	USGS MON FLUSH SE COR AVE B + 60TH ST W 27FT S + 32FT E C/L INT MKD (R 27 1929)	BL 867
LANCASTR (1972)	2382.668	L+T IN CONC APRON GARAGE SE COR 60TH ST W + PROP AVE B-8 15FT S + 118FT E C/L INT MKD (BM)	BL 869
LANCASTR (1972)	2381.457	RDBM MON IN WELL 8IN DN SE COR 60TH ST W + PROP AVE C 160FT S + 22FT E C/L INT 2IN IP MARKER 2FT E 3FT UP	BL 871
LANCASTR (1972)	2382.597	RD MON IN WELL 8IN DN NE COR 60TH ST W + AVE C-8 5FT N + 90FT E C/L INT 2IN IP MARKER 2FT N 3FT UP	BL 873

QUAD-YEAR	ELEV	DESCRIPTION (INCLUDE QUAD AND YEAR IN DESCRIPTION)	BM NUMBER
LANCASTR (1972)	2384.631	USC+GS BR CAP IN CONC HDWL @ NE COR AVE D + 60TH ST W 30FT N + 30FT E C/L INT MKD (B1154 1961)	BL 874
LANCASTR (1972)	2385.086	ST HWY BR CAP IN CONC IN HDWL NW COR 60TH ST W + AVE D 40FT N + 24FT W C/L INT	BL 875
LANCASTR (1972)	2375.429	L+T IN CONC SLAB OF HSE SE COR 60TH ST W + AVE D-8 120FT E + 70FT S C/L INT	BL 877
LANCASTR (1972)	2359.851	CS MON 6IN DN @ C/L INT 60TH ST W + PROP AVE E MKD (T8N R13W 22-23-26-27)	BL 878
LANCASTR (1972)	2358.303	RD MON IN WELL 8IN DN SW COR 60TH ST W + PROP AVE E 115FT S + 30FT W C/L INT 2IN IP MARKER 2FT W 3FT UP	BL 879
LANCASTR (1972)	2352.377	L+T 2IN DN @ C/L INT 60TH ST W + AVE F	BL 882
LANCASTR (1972)	2352.952	CS MON 2IN UP SE COR 60TH ST W + AVE F 31FT S + 75FT E C/L INT MKD (BM 103-11 1957)	BL 883
LANCASTR (1972)	2351.908	L+T IN CONC CROSS GUTTER @ C/L INT 60TH ST W + PROP AVE F-8	BL 884
LANCASTR (1972)	2352.449	RDBM TAG IN CONC FTG 5FT CHAIN LINK FEN AROUND AIRPORT SE COR 60TH ST W + PROP AVE F-8 60FT S + 50FT E C/L INT	BL 885
LANCASTR (1972)	2352.068	RDBM TAG SE COR FTG OF AIRPORT FENCE @ NE COR 60TH ST W + AVE G 50FT N + 50FT E C/L INT	BL 886
LANCASTR (1972)	2353.417	CS MON IN WELL 18IN DN @ C/L INT 60TH ST W + AVE G MKD (T7N T8N R13W 2-3-34-35)	BL 887
LANCASTR (1972)	2357.064	CS MON IN WELL 17IN DN @ C/L INT 60TH ST W + PROP AVE G-8 MKD (T7N R13W 2-3)	BL 888
LANCASTR (1972)	2357.914	RD MON IN WELL 8IN DN SW COR 60TH ST W + PROP AVE G-8 180FT S + 31FT W C/L INT 2IN IP MARKER 2FT W 3FT UP	BL 889
LANCASTR (1972)	2351.996	CS MON 3IN UP SE COR 60TH ST W + PROP AVE H-8 42FT S + 42FT E C/L INT MKD (BM 103-16 1957)	BL 893
LANCASTR (1972)	2389.111	CS MON 8IN DN @ C/L INT AVE D + PROP 65TH ST W MKD (T8N R13W 22-15) (E EDGE)	BL 894
LANCASTR (1972)	2390.342	RDBM MON IN WELL 8IN DN NW COR AVE D + PROP 65TH ST W 30FT N + 180FT W C/L INT 2IN IP MARKER 2FT N 3FT UP	BL 895
LANCASTR (1972)	2397.218	CS MON (N EDGE) IN WELL 18IN DN @ C/L INT AVE D + 70TH ST W MKD (15 16 21 22 T8N R13W)	BL 896
LANCASTR (1972)	2410.972	RDBM TAG IN 12IN CONC STANDPIPE NE COR AVE D + 75TH ST W 55FT N + 40FT E C/L INT	BL 898
LANCASTR (1972)	2407.528	CS MON (E EDGE) IN WELL 16IN DN @ C/L INT 75TH ST W + AVE D MKD (16 21 T8N R13W)	BL 899
LANCASTR (1972)	2415.991	CS MON IN WELL 24IN DN @ C/L INT 80TH ST W + AVE D MKD (16 17 20 21 T8N R13W)	BL 900
LANCASTR (1972)	2418.224	L+T IN NW CONC FTG OF HAY BARN ON SE COR AVE D + 80TH ST W 32FT S + 50FT E C/L INT MKD (BM)	BL 901

QUAD-YEAR	ELEV	DESCRIPTION (INCLUDE QUAD AND YEAR IN DESCRIPTION)	BM NUMBER
LANCASTR (1972)	2426.486	RDBM MON IN WELL 8IN DN NE COR AVE D + 85TH ST W 105FT E + 28FT N C/L INT 2IN IP MARKER 2FT N 3FT UP	BL 902
LANCASTR (1972)	2426.080	CS MON (E EDGE) IN WELL 14IN DN @ C/L INT AVE D + 85TH ST W MKD (17 20 T8N R13W)	BL 903
BASELINE (1965)	2567.027	CSBM MON 5IN UP 30FT S + 90FT W C/L INT AVE M + 65TH ST W MKD (BM 104-16 1958)	BL 904A
BASELINE (1965)	2610.051	CSBM MON 5IN UP 76FT N + 44FT W C/L INT AVE M + 70TH ST W 4FT N PP 1183862E MKD (BM 104-17 1958)	BL 905
LANCASTR (1972)	2515.540	CSBM MON 5IN UP ON SW COR 70TH ST W + AVE L-8 66FT S + 46FT W C/L INT MKD (BM 104-18 1958)	BL 906
LANCASTR (1972)	2445.012	CSBM MON 4IN UP ON SW COR 70TH ST W + AVE L 78FT S + 28FT W C/L INT MKD (BM 104-19 1958)	BL 907
LANCASTR (1972)	2378.456	CSBM MON 5IN UP ON NW COR 70TH ST W + AVE K 32FT N + 32FT W C/L INT MKD (BM 104-21 1958)	BL 909
LANCASTR (1972)	2362.478	CSBM MON 5IN UP ON NW COR 70TH ST W + AVE J-8 280FT N + 30FT W C/L INT MKD (BM 104-22 1958)	BL 910
LANCASTR (1972)	2357.807	CSBM MON 5IN UP ON SW COR AVE J + 70TH ST W 55FT S + 30FT W C/L INT MKD (BM 104-23 1958)	BL 911
LANCASTR (1972)	2359.518	CSBM MON 5IN UP ON NW COR 70TH ST W + AVE I-8 350FT N + 26FT W C/L INT MKD (BM 104-24 1958)	BL 912
BASELINE (1965)	2442.674	LACS BM MON 2IN UP 45FT N + 40FT E C/L INT 90TH ST E + AVE J MKD BM 107-24 1961	BL 1075B
BASELINE (1965)	2342.585	CSBM MON 6IN UP 32FT E C/L 90TH ST E + 46FT S C/L AVE E 7FT SE PP 538296E MKD (BM 106-122 1959)	BL 1165B
BASELINE (1965)	2347.538	RDBM TAG CONC FOOTING OF SUPPORT @ NW COR HAY SHED 50FT E C/L 90TH ST E + 50FT S C/L AVE E-8	BL 1167B
BASELINE (1965)	2356.293	90TH ST E MKD BM 116-6 1961 CSBM MON 2IN UP 30FT N + 77FT E C/L INT AVE F +	BL 1168B
BASELINE (1965)	2365.866	LACS BM MON 2IN UP 80FT N + 30FT E C/L INT 90TH ST E + AVE F-8 MKD BM 116-5 1961	BL 1169B
BASELINE (1965)	2375.401	LACS BM MON 4IN UP 70FT S + 27FT W C/L INT 90TH ST E + AVE G MKD BM 116-4 1961	BL 1170B
BASELINE (1965)	2384.640	CSBM MON 4IN UP 80FT E C/L 90TH ST E + 20FT S C/L AVE G-8 25FT W PP 951530E MKD (BM 116-3 1961)	BL 1171B
BASELINE (1965)	2395.866	LACS BM MON FL 35FT N + 115FT E C/L INT 90TH ST E + AVE H MKD BM 116-2 1961	BL 1172B
BASELINE (1965)	2403.308	LACS BM MON 3IN UP 155FT N + 30FT E C/L INT 90TH ST E + FUT AVE H-8 MKD 116-1 1961	BL 1173B
BASELINE (1965)	2414.089	LACS BM MON 4IN UP 30FT S + 68FT W C/L INT 90TH ST E + AVE I 2FT E/O PP NO 955497E MKD BM 107- 26 1961	BL 1174B
BASELINE (1965)	2424.728	LACS BM MON 2IN UP 550FT N + 35FT E C/L INT 90TH ST E + AVE I-8 3FT E/O PP NO 771405E MKD BM 107- 25 1961	BL 1175B

QUAD-YEAR	ELEV	DESCRIPTION (INCLUDE QUAD AND YEAR IN DESCRIPTION)	BM NUMBER
BASELINE (1965)	2456.082	CSBM MON 4IN UP 90FT W C/L 90TH ST E + 29FT S C/L AVE J-8 1FT N OF N P/L GLENDALE AUTO PARTS YD MKD (BM 107-23 1961)	BL 1177B
BASELINE (1965)	2475.322	LACS BM MON 60FT S + 27FT W C/L INT 90TH ST E + AVE K 2FT W/O PP NO K9248Y MKD BM 107-22 1961	BL 1178B
BASELINE (1965)	2490.428	LACS BM MON 3IN UP 45FT S + 33FT E C/L INT 90TH ST E + AVE K-8 3FT E/O PP NO 771366E MKD BM 107 -21 1961	BL 1179B
BASELINE (1965)	2498.198	LACS BM MON 8IN DN 30FT S + 60FT W C/L INT 90TH ST E + AVE L 3FT S/O PP 800334E MKD BM 107-20 1961	BL 1180B
BASELINE (1965)	2513.399	LACS BM MON 35FT N + 34FT E C/L INT 90TH ST E + AVE L-8 3FT S/O PP 771347E MKD BM 107-19 1961	BL 1181B
BASELINE (1965)	2526.141	CSBM MON 4IN UP 36FT N C/L AVE M + 36FT E C/L 90TH ST E MKD (BM 107-18 1961)	BL 1182A
LANCASTER (1972)	2448.761	CS MON 14IN DN @ C/L INT AVE D (PAVED) + 95TH ST W (DIRT RD) MKD (T8N R13W 1/4 SEC COR 18-19) (NW EDGE)	BL 1208
LANCASTER (1972)	2461.584	RDBM TAG 1FT N OF S EDGE + 8FT E OF W EDGE CONC SLAB 110FT N C/L AVE D + 215FT E C/L 100TH ST W	BL 1209
LANCASTER (1972)	2460.544	CS MON (S EDGE) IN WELL 20IN DN @ C/L INT AVE D + 100TH ST W MKD (SEC COR 13 18 19 24 T8N R13W R14W)	BL 1210
LANCASTER (1972)	2472.151	CS MON 24IN DN @ C/L INT AVE D + 105TH ST W (DIRT RD) MKD (T8N R14W 1/4 SEC COR 13,24) (W EDGE)	BL 1212
BASELINE (1965)	2485.338	CS MON (SW EDGE) IN WELL 14IN DN @ C/L INT AVE D + 110TH ST W MKD (SEC COR 13 14 23 24 T8N R14W)	BL 1213
BASELINE (1965)	2497.288	CS MON IN WELL 15IN DN 5FT N C/L INT AVE I + 110TH ST W MKD (SEC COR 11 12 13 14 R14W T7N)	BL 1303
LANCASTER (1972)	2480.849	USC+GS MON FLUSH 33FT N C/L AVE I + 125FT W C/L 105TH ST W 14FT SE OF SW COR EDISON TOWER 57-4 MKD (A 306 1935)	BL 1304
LANCASTER (1972)	2477.164	CS MON IN WELL 14IN DN @ C/L INT AVE I + 105TH ST W MKD (1/4 COR 12 13 R14W T7N)	BL 1305
LANCASTER (1972)	2455.892	CS MON IN WELL 18IN DN @ C/L INT AVE I + 100TH ST W MKD (SEC COR 7 12 13 18 T7N R14W R13W)	BL 1306
LANCASTER (1972)	2436.575	CSBM MON FLUSH 56FT S C/L AVE I @ 95TH ST W UNDER EDISON TOWER M2624 MKD (BM 102-21 1957)	BL 1307
LANCASTER (1972)	2417.514	USGS MON 24IN UP 298FT E C/L 90TH ST W + 0.2MI N AVE I 89FT S FIELD RD TO HAYSHED 274FT NE OF NE COR METAL SHED OVER WELL MKD (LINT DEL SUR)	BL 1308
BASELINE (1965)	2525.428	CSBM MON 5IN UP 34FT N C/L AVE M + 175FT E C/L 35TH ST W 6FT E PP 1054605E MKD (BM 104-7 1958)	BL 1373A
BASELINE (1965)	2516.776	CS MON IN WELL @ C/L INT AVE M + 35TH ST W MKD (1/4 COR 31 6 R12W T7N T6N)	BL 1374A
BASELINE (1965)	2567.496	CS MON IN WELL 18IN DN @ C/L INT AVE M + 45TH ST W MKD 1/4 COR SEC 1 36 T6N T7N R13W	BL 1376

QUAD-YEAR	ELEV	DESCRIPTION (INCLUDE QUAD AND YEAR IN DESCRIPTION)	BM NUMBER
BASELINE (1965)	2529.461	CSBM MON 4IN UP 28FT S + 41FT W C/L INT AVE M + 47TH ST W 4FT W PP 168073E MKD (BM 104-12 1958)	BL 1377A
LANCASTER (1972)	2463.857	USGS MON 10IN UP (LEANING N) 0.25MI N AVE L + 150FT E C/L SIERRA HWY MKD (2462 B 36 1902) MARKER POST 1FT W	BL 1426
LANCASTER (1972)	2423.110	CSBM MON 2IN DN ON SE COR SIERRA HWY + AVE K 198FT S + 62FT E C/L INT MKD (BM 101-126 1957)	BL 1427
LANCASTER (1972)	2422.127	L+BN SE COR CONC APRON OF GAS STA ON SW COR SIERRA HWY + AVE K 133FT S + 61FT W C/L INT MKD (BL)	BL 1428
LANCASTER (1972)	2396.725	RDBM TAG N CB 1FT W BCR @ NW COR SIERRA HWY + AVE J8 86FT W + 18FT N C/L INT	BL 1429
LANCASTER (1972)	2326.233	L+BR W CB 1FT N BCR @ SW COR AVE H8 + BEECH AVE 49FT S + 20FT W C/L INT	BL 1430
LANCASTER (1972)	2325.537	SQ HD SPK N CB 4FT W BCR @ NW COR AVE H8 + BEECH AVE 25FT N + 48FT W C/L INT	BL 1431
LANCASTER (1972)	2325.664	RDBM TAB W END OF N HDWL ON NW COR SIERRA HWY + AVE H 30FT N + 49FT W C/L INT	BL 1432
LANCASTER (1972)	2324.988	CSBM MON 3IN UP ON NE COR SIERRA HWY + AVE H 155FT N + 90FT E C/L INT MKD (BM 101-135 1957)	BL 1433
LANCASTER (1972)	2316.408	6X6 CONC POST W/RAM SET 50FT S CULV G90+50 57FT W C/L SIERRA HWY + 0.6MI N AVE H POST MKD (C)	BL 1434
LANCASTER (1972)	2314.215	CS MON ON NE COR SIERRA HWY + AVE G 124FT N + 97FT E C/L INT MKD (BM 101-137 1957) SURVEY MARKER SIGN 3FT UP 1FT W	BL 1435
LANCASTER (1972)	2314.214	RDBM TAG CTR OF S HDWL ON NW COR SIERRA HWY + AVE G 185FT N + 35FT W C/L INT	BL 1436
LANCASTER (1972)	2307.770	RDBM TAG CTR OF S HDWL ON NW COR SIERRA HWY + AVE F8 (PROP) 200FT N + 50FT W C/L INT	BL 1437
LANCASTER (1972)	2307.573	L+BN CTR OF N HDWL ON NW COR SIERRA HWY + AVE F8 (PROP) 225FT N + 50FT W C/L INT MKD (BM)	BL 1438
LANCASTER (1972)	2306.398	RDBM TAG CONC BASE OF SEMAPHORE NO 4022 123FT E C/L SIERRA HWY + 0.1MI S AVE F	BL 1439
LANCASTER (1972)	2302.111	RD HD SPK IN CHIS SQ N END E HDWL BRIDGE @ G215 +50 ON NE COR SIERRA HWY + AVE E 88FT N + 43FT E C/L INT	BL 1440
LANCASTER (1972)	2301.996	L+PK NAIL N END OF E HDWL OF BRIDGE NO 53-510 0.15MI S AVE D8 (PROP) 25FT E C/L SIERRA HWY	BL 1441
LANCASTER (1972)	2298.999	CSBM MON 2IN UP ON SE COR SIERRA HWY + AVE D8 (PROP) 90FT E + 250FT S C/L INT MKD (BM 101-144 1957)	BL 1442
LANCASTER (1972)	2303.265	RDBM TAG W CB SIERRA HWY (E CB OF ISLAND) 31FT W C/L + 20FT S C/L AVE D (HWY 138)	BL 1443
LANCASTER (1972)	2301.532	L+PK NAIL CTR OF N HDWL ON NW COR SIERRA HWY + AVE D (HWY 138) 172FT W + 50FT N C/L INT	BL 1444
LANCASTER (1972)	2302.868	6X6 CONC POST W/NAIL 10IN UP ON SW COR SIERRA HWY + AVE C8 (PROP) NR NE COR CO SANITATION DIST YD NO 14 50FT S + 56FT W C/L INT POST MKD (C)	BL 1445

QUAD-YEAR	ELEV	DESCRIPTION (INCLUDE QUAD AND YEAR IN DESCRIPTION)	BM NUMBER
LANCASTR (1972)	2301.231	CSBM MON 2IN UP ON NE COR SIERRA HWY + PROPOSED AVE C 8 275FT N + 40FT E C/L INT MKD (BM 101-146 1957)	BL 1446
LANCASTR (1972)	2304.583	RDBM TAG N END BRIDGE 53-512 25FT W C/L SIERRA HWY + 90FT N C/L AVE C	BL 1447
LANCASTR (1972)	2304.191	RDBM TAG N END CONC HDWL 25FT W C/L SIERRA HWY + 0.6MI N AVE C	BL 1448
LANCASTR (1972)	2304.061	8IN DIA CONC POST W/IRON SPK 35FT E C/L SIERRA HWY 0.75MI N AVE C 2FT IP MARKER 1FT S MKD (W56)	BL 1449
LANCASTR (1972)	2303.501	WIRE SPK S END CONC HDWL OF CULV G383+10 25FT E C/L SIERRA HWY + 106FT S C/L AVE B	BL 1450
LANCASTR (1972)	2307.273	RD HD SPK S END E HDWL BRIDGE 53-514 25FT E C/L SIERRA HWY + 0.65MI N AVE B MKD (BM 101-150)	BL 1451
LANCASTR (1972)	2307.315	RDBM TAG N END W HDWL BRIDGE 53-514 25FT W C/L SIERRA HWY + 0.65MI N AVE B	BL 1452
LANCASTR (1972)	2307.186	WIRE SPK S END CONC HDWL OF CULV G426+19 ON SE COR SIERRA HWY + AVE A 25FT E + 208FT S C/L INT	BL 1453
LANCASTR (1972)	2306.068	RDBM TAG CTR N HDWL OF CULV NO 1.38 23FT N C/L AVE D + 15FT W C/L 15TH ST W (PROP)	BL 1455
LANCASTR (1972)	2312.256	USC+GS BR DISK IN NW COR OF E CONC HDWL @ ENT TO SANITATION DIST NO 14 YD 39FT N C/L AVE D + 155FT E C/L PROP 20TH ST W MKD (D1154 1961)	BL 1456
LANCASTR (1972)	2311.237	L+PK IN W END CONC GATE PAD TO SANITATION DIST NO 14 YD 40FT N C/L AVE D + 125FT E C/L PROP 20TH ST W MKD (2314.170)	BL 1457
LANCASTR (1972)	2317.572	RDBM TAG CTR OF CONC HDWL L 1185+00 23FT N C/L AVE D + 75FT E C/L PROP 25TH ST W	BL 1458
LANCASTR (1972)	2319.109	RDBM TAG CTR OF CONC HDWL L 1176+00 21FT N C/L AVE D + 816FT W C/L PROP 25TH ST W	BL 1459
LANCASTR (1972)	2327.767	CHIS X ON ANCHOR BOLT IN WATER TANK FOOTING ON NE COR AVE D + 30TH ST W (PROP) 127FT N + 3FT E C/L INT	BL 1460
LANCASTR (1972)	2334.351	RDBM TAG CTR CONC HDWL L 1134+00 21FT N C/L AVE D + 330FT E C/L PROP 35TH ST W	BL 1462
LANCASTR (1972)	2337.543	RDBM TAG CTR CONC HDWL L 1125+00 21FT N C/L AVE D + 570FT W C/L PROP 35TH ST W	BL 1463
LANCASTR (1972)	2342.897	USGS MON 12IN UP ON SE COR AVE D + 40TH ST W 40FT S + 12FT E C/L INT MKD (R46 1929) (NW 1/4)	BL 1464
LANCASTR (1972)	2344.924	RDBM TAG CTR CONC HDWL L 1101+00 21FT N C/L AVE D + 356FT W C/L PROP 40TH ST W	BL 1465
LANCASTR (1972)	2351.022	STATE HWY BR CAP CTR CONC HDWL L 1085+00 21FT N C/L AVE D + 964FT E C/L PROP 45TH ST W	BL 1466
LANCASTR (1972)	2353.889	CS MON 20IN DN ON C/L INT AVE D + 45TH ST W MKD (1/4 SEC COR 13-24 T8N R13W)	BL 1467
LANCASTR (1972)	2367.001	USC+GS REF MON 6IN UP ON NE COR AVE D + 50TH ST W 95FT N + 61FT E C/L INT MKD (AVENUE NO 1 1960)	BL 1468

QUAD-YEAR	ELEV	DESCRIPTION (INCLUDE QUAD AND YEAR IN DESCRIPTION)	BM NUMBER
LANCASTR (1972)	2367.746	USC+GS MON 4IN UP ON NW COR AVE D + 50TH ST W 102FT N + 92FT W C/L INT MKD (AVENUE 1960)	BL 1469
LANCASTR (1972)	2375.714	RDBM TAG CTR OF CONC HDWL L 1030+00 21FT N C/L AVE D + 490FT E C/L PROPOSED 55TH ST W	BL 1470
LANCASTR (1972)	2377.604	2IN IP W/CUT SPK + CONC COLLAR ON C/L PROP 55TH ST W + 45FT S C/L AVE D	BL 1471
LANCASTR (1972)	2458.545	CS MON IN WELL 24IN DN @ C/L INT 50TH ST W + AVE L8 MKD (1/4 SEC COR 35-36 T7N R13W 1928)	BL 1473
LANCASTR (1972)	2363.614	CS MON IN WELL 12IN DN @ C/L INT 50TH ST W + PROPOSED AVE J8 MKD (1/4 COR 23-24 R13W T7N) USE S EDGE	BL 1474
LANCASTR (1972)	2393.156	CHIS (X) ON W BOLT OF FIRE HYDT ON SW COR AVE K + 15TH ST W 40FT S + 65FT W C/L INT OUT	BL 1477
LANCASTR (1972)	2365.947	CS MON 2IN UP ON C/L 15TH ST E 30FT S C/L AVE I 12FT N + 12FT E PP 1491371E MKD (WC SEC 13 T7N R12W) (W EDGE)	BL 1478
LANCASTR (1972)	2378.258	L+BN CONC FOOTING OF GATEPOST SW COR AVE K + 70TH ST W 40FT S + 103 FT W APPROX C/L INT MKD (BM)	BL 1804
LANCASTR (1972)	2381.922	2IN IP WITH CE TAG 6IN UP ON SE COR AVE K + 75TH ST W PROP 50FT S + 50FT E APPROX C/L INT	BL 1805
LANCASTR (1972)	2380.318	CS MON 12IN DN IN WELL @ C/L INT AVE K + 75TH ST W MKD (21 28 T7N R12W)	BL 1806
LANCASTR (1972)	2395.797	CS MON IN WELL 18IN DN @ C/L INT AVE K + 80TH ST W MKD (20 21 28 29 T7N R13W)	BL 1807
LANCASTR (1972)	2427.592	CS MON IN WELL 10IN DN @ C/L INT AVE K + 85TH ST W MKD (1/4 COR 20 29 T7N R13W)	BL 1809
LANCASTR (1972)	2430.068	2IN IP WITH CE TAG 8IN UP ON NW COR AVE K + 85TH ST W PROP 50FT N + 50FT W APPROX C/L INT (N EDGE)	BL 1810
LANCASTR (1972)	2469.993	1.5IN IP + BRAD FLUSH ON SE COR AVE K + 90TH ST W 50FT S + 50FT E APPROX C/L INT	BL 1811
LANCASTR (1972)	2491.416	1.5IN IP NR CTR TOWER NO 35-1 75FT S C/L AVE K + 600FT W C/L 90TH ST W (S EDGE)	BL 1812
LANCASTR (1972)	2523.756	2IN IP WITH CE TAG 2IN DN ON SE COR AVE K + 95TH ST W PROP 50FT S + 50FT E APPROX C/L INT	BL 1813
LANCASTR (1972)	2523.695	2IN IP WITH CE TAG 4IN DN ON NW COR AVE K + 95TH ST W PROP 50FT N + 50FT W APPROX C/L INT	BL 1814
LANCASTR (1972)	2583.132	RDBM MON 8IN DN 20FT E C/L 100TH ST W PROP ON TP LINE + 90FT N C/L AVE K 2IN IP MARKER 3FT UP + 2FT N	BL 1816
LANCASTR (1972)	2530.548	RDBM MON 8IN DN ON TP LINE 20FT E C/L 100TH ST W + 33FT N C/L AVE J-8 2IN IP MKR 3FT UP 2FT N	BL 1818
LANCASTR (1972)	2470.685	CS MON 18IN DN IN WELL @ C/L INT AVE J + 100TH ST W MKD (SEC COR 24 19 13 18 R13W R14W T7N)	BL 1819
LANCASTR (1972)	2467.193	L+BN CONC FOOTING TOWER 25-5 100FT E C/L 100TH ST W + 500FT N AVE J	BL 1820

QUAD-YEAR	ELEV	DESCRIPTION (INCLUDE QUAD AND YEAR IN DESCRIPTION)	BM NUMBER
LANCASTR (1972)	2456.384	2IN IP 12IN UP ON SE COR 100TH ST W PROP AVE I-8 PROP 40FT S + 40FT E APPROX OUT	BL 1821
LANCASTR (1972)	2454.479	CS MON 6IN DN @ C/L INT 100TH ST W + FUT AVE I-8 MKD (1/4 COR 13 18 T7N R13W R14W)	BL 1822
BASELINE (1965)	2610.458	CS MON IN WELL 8IN DN @ C/L INT AVE M + 70TH ST W MKD (33 34 4 3 T6N T7N R13W)	BL 1997
BASELINE (1965)	2561.273	CS MON IN WELL 22IN DN @ C/L INT AVE M + 65TH ST W MKD (1/4 COR 34 3 T6N T7N R13W)	BL 1998
BASELINE (1965)	2512.526	L+BN CONC BASE FIRE HYD PROTECTION PIPE @ NE COR AVE M + 60TH ST W 75FT N + 40FT E C/L INT MKD (BM)	BL 1999
BASELINE (1965)	2501.265	CSBM MON 4IN UP ON SW COR AVE M + 55TH ST W 39FT S + 37FT W C/L INT MKD (BM 104-14 1958)	BL 2000A
BASELINE (1965)	2519.783	CSBM MON 4IN UP ON NE COR AVE M + 25TH ST W 34FT N + 60FT E C/L INT MKD (BM 104-5 1958)	BL 2001
BASELINE (1965)	2519.273	CS MON IN WELL 6IN DN @ C/L INT AVE M + 15TH ST W MKD (1/4 COR 33 4 T7N T6N R12W)	BL 2002
BASELINE (1965)	2518.450	CSBM MON 4IN UP ON NE COR AVE M + 15TH ST W 31FT N + 215FT E C/L INT MKD (BM 104-3 1958)	BL 2003
BASELINE (1965)	2522.622	CS MON 21IN DN IN WELL @ C/L INT AVE M + 10TH ST W MKD (SEC COR 3 4 33 34 T7N T6N R12W 1928)	BL 2004
BASELINE (1965)	2528.538	CS MON IN WELL 21IN DN @ C/L INT AVE M + 5TH ST W MKD (1/4 COR 34 3 T7N T6N R12W)	BL 2006
LANCASTR (1972)	2436.502	RDBM MON IN WELL 8IN DN ON SW COR 90TH ST W + AVE D-8 210FT S + 46FT W C/L INT 2IN IP MKR 3FT UP 2FT W	BL 2007
BASELINE (1965)	2532.284	RDBM TAG N CB AVE M 40FT N C/L + 250FT E C/L 5TH ST W IN FRONT OF COUNTY DISPATCH CENTER	BL 2008
BASELINE (1965)	2519.425	CSBM MON IN CONC POST 4IN UP ON NW COR AVE M + 5TH ST E 40FT N + 100FT W C/L INT MKD (BM 121-1 1961)	BL 2009A
BASELINE (1965)	2518.546	CS MON 8IN DN IN WELL @ C/L INT AVE M + 5TH ST E MKD (1/4 COR 35 2 T6N T7N R12W)	BL 2010
BASELINE (1965)	2504.285	CSBM MON 4IN UP ON NW COR AVE M + 10TH ST E 72FT N + 40FT W C/L INT MKD (BM 121-2 1961)	BL 2011
BASELINE (1965)	2504.101	CS MON IN WELL 8IN DN @ C/L INT AVE M + 10TH ST E MKD (SEC COR 35 36 1 2 R12W T6N T7N)	BL 2012
BASELINE (1965)	2487.357	CSBM MON 4IN UP ON SW COR AVE M + 15TH ST E 40FT S + 50FT W C/L INT MKD (BM 121-3 1961)	BL 2013
BASELINE (1965)	2486.367	L+BN CONC FOOTING 4FT BARBED WIRE FENCE @ SE COR AVE M + 15TH ST E 40FT S + 30FT E C/L INT MKD (BM)	BL 2014
BASELINE (1965)	2477.314	CSBM MON 4IN UP ON SW COR AVE M + 20TH ST E 68FT W + 40FT S C/L INT MKD (BM 121-4 1961)	BL 2015
BASELINE (1965)	2476.204	L+BN CONC FOOTING 7FT CHAIN LINK FENCE @ NW COR AVE M + 20TH ST E 50FT N + 45FT W C/L INT MKD (BM)	BL 2016

QUAD-YEAR	ELEV	DESCRIPTION (INCLUDE QUAD AND YEAR IN DESCRIPTION)	BM NUMBER
BASELINE (1965)	2470.415	CSBM MON 4IN UP 38FT S C/L AVE M + 229FT W C/L 25TH ST E MKD (BM 121-5 1961) 2IN IP MKR 3FT UP 2FT N	BL 2017A
BASELINE (1965)	2469.941	L+BN CONC FOOTING 7FT CHAIN LINK FENCE ON NE COR AVE M + 25TH ST E 40FT N + 500FT E C/L INT MKD (BM)	BL 2018B
BASELINE (1965)	2471.165	CSBM MON 4IN UP ON SW COR AVE M + 30TH ST E 38FT S + 125FT W C/L INT MKD (BM 121-6 1961) 2IN IP MKR 3FT UP 2FT N	BL 2019A
BASELINE (1965)	2471.625	L+BN CONC FOOTING COR FENCE POST @ SE COR AVE M + 30TH ST E 40FT S + 40FT E C/L INT MKD (BM)	BL 2020B
BASELINE (1965)	2472.513	CSBM MON 4IN UP 38FT S C/L AVE M + 585FT W 35TH ST E MKD (BM 121-7 1961) 2IN IP MKR 3FT UP 2FT N	BL 2021B
BASELINE (1965)	2474.780	L+BN CONC IRRIG STANDPIPE 30FT N C/L AVE M + 30FT W C/L FUT 35TH ST E MKD (BM)	BL 2022A
BASELINE (1965)	2473.542	CSBM MON 4IN UP ON SE COR AVE M + 40TH ST E 38FT S + 34FT E C/L INT MKD (BM 121-8 1961) 2IN IP MKR 3FT UP 2FT N	BL 2023B
BASELINE (1965)	2473.543	L+BN CONC OF 4FT STANDPIPE ON NE COR AVE M + 40TH ST E 30FT N + 28FT E C/L INT MKD (BM)	BL 2024A
BASELINE (1965)	2473.616	CSBM MON 4IN UP ON SW COR AVE M + FUT 45TH ST E 37FT S + 90FT W C/L INT MKD (BM 121-9 1961) 2IN IP MKR 3FT UP 2FT N	BL 2025A
BASELINE (1965)	2472.726	CS MON IN WELL 10IN DN @ C/L INT AVE M + FUT 45TH ST E MKD (1/4 COR 33 4 T6N T7N R11W)	BL 2026A
BASELINE (1965)	2476.719	CS MON 30IN DN IN WELL @ C/L INT AVE M + 50TH ST E MKD (SEC COR 3 4 33 34 T6N T7N R11W)	BL 2027B
BASELINE (1965)	2480.076	CSBM MON 6IN UP ON SE COR AVE M + 50TH ST E 95FT S + 36FT E C/L INT MKD (BM 120-2 1961) 2IN IP MKR 3FT UP 2FT W	BL 2028B
BASELINE (1965)	2483.383	CSBM MON 4IN UP 32FT N C/L AVE M + 450FT W 55TH ST E MKD (BM 121-10 1961) 2IN IP MKR 3FT UP 2FT W	BL 2029B
BASELINE (1965)	2487.230	CSBM MON 4IN UP @ NW COR FUT AVE M + 60TH ST E 30FT N + 42FT W C/L INT MKD (BM 121-11 1961) 2IN IP MKR 3FT UP 2FT S	BL 2030B
BASELINE (1965)	2484.744	LACS MON 8IN DN @ FUTURE C/L INT OF AVE M + 65TH ST E MKD 1/4 COR 35 2 T6N T7N R11W 2IN IP 3FT U 2FT S	BL 2031A
BASELINE (1965)	2496.488	CS MON @ C/L INT FUT AVE M + 75TH ST E MKD (1/4 COR 36 1 T6N T7N R11W)	BL 2033
BASELINE (1965)	2499.442	RDBM MON IN WELL 8IN DN ON NW COR FUT AVE M + 80TH ST E 160FT N + 23FT W C/L INT BET PP 1185566E + DEADMAN 2IN IP MKR 3FT UP 2FT W	BL 2034A
BASELINE (1965)	2514.843	CS MON 14IN DN @ C/L INT FUT AVE M + 85TH ST E MKD (1/4 COR 31 6 T6N T7N R10W) 2IN IP MKR 3FT UP 2FT E	BL 2035A
BASELINE (1965)	2666.035	RDBM TAG CONC COLLAR FIRE HYD @ SE COR AVE M + FUT 75TH ST W 28FT S + 40FT E C/L INT	BL 2057

QUAD-YEAR	ELEV	DESCRIPTION (INCLUDE QUAD AND YEAR IN DESCRIPTION)	BM NUMBER
BASELINE (1965)	2706.638	USC+GS MON IN SE LEG EDISON TOWER 62-3 50FT N C/L AVE M + 800FT E 80TH ST W MKD (A 1045 1960)	BL 2058
BASELINE (1965)	2721.725	RDBM MON IN WELL 8IN DN @ NW COR FUT AVE M + 80TH ST W 20FT N + 15FT W C/L INT 2IN IP MKR 3FT UP 2FT W	BL 2059
BASELINE (1965)	2864.391	CS MON 12IN DN @ FUT C/L INT AVE M + 85TH ST W MKD (1/4 SEC COR 32 5 T6N T7N R13W)	BL 2060
BASELINE (1965)	2756.738	CS MON 12IN DN @ FUT C/L INT AVE L-8 + 90TH ST W MKD (1/4 COR 31 32 R13W T7N)	BL 2062
BASELINE (1965)	2702.222	USC+GS MON FLUSH 20FT S C/L AVE L (DIRT RD) + 0.4MI W 90TH ST W NR FUT 94TH ST W MKD (X 1044 1960)	BL 2063A
BASELINE (1965)	2710.852	CS MON 24IN DN @ FUT C/L INT AVE L + 95TH ST W MKD (1/4 COR 30 31 T7N R13W)	BL 2064B
BASELINE (1965)	2761.762	CS MON 24IN DN @ FUT C/L INT AVE L + 100TH ST W MKD (SEC COR 25 30 36 31 T7N R13W R14W)	BL 2065
LANCASTR (1972)	2372.041	RDBM TAG E CB FRONT OF WATER TANKS 40FT E C/L 50TH ST W + 0.3MI N AVE K	BL 2079
LANCASTR (1972)	2349.603	2IN IP + CS TAG 3IN UP ON NW COR 50TH ST W + AVE J 60FT N + 60FT W C/L INT	BL 2080
LANCASTR (1972)	2352.541	USC+GS MON 3IN UP ON NE COR 60TH ST W + AVE G 72FT N + 49FT E C/L INT MKD (W 1154 1961)	BL 2081
LANCASTR (1972)	2342.738	CSBM MON 4IN UP 42FT S C/L AVE I + 0.5MI W 50TH ST W MKD (BM 102-11B 1962) 2IN IP MKR 3FT UP 2FT N	BL 2082
LANCASTR (1972)	2346.507	CSBM MON E HDWL DRIVE TO MIRA LOMA FACILITY 30FT S C/L AVE I + 1200FT E 60TH ST W MKD (BM 102-11A 1962)	BL 2083
LANCASTR (1972)	2362.629	CS MON IN WELL 10IN DN ON C/L 70TH ST W 33FT S C/L AVE I MKD (SEC COR 9 10 15 16 R13W T7N)	BL 2084
LANCASTR (1972)	2357.520	CS MON IN WELL 18IN DN @ C/L INT 70TH ST W + FUT AVE I-8 MKD (1/4 COR 16 15 R13W T7N)	BL 2085
LANCASTR (1972)	2355.883	CS MON IN WELL 18IN DN @ C/L INT 70TH ST W + AVE J MKD (SEC COR 15 16 21 22 R13W T7N)	BL 2086
LANCASTR (1972)	2361.717	CS MON IN WELL 16IN DN @ C/L INT 70TH ST W + FUT AVE J-8 MKD (1/4 COR 21 22 R13W T7N)	BL 2087
LANCASTR (1972)	2399.605	CS MON IN WELL 20IN DN @ C/L INT 70TH ST W + FUT AVE K-8 MKD (1/4 COR 27 28 R13W T7N)	BL 2088
LANCASTR (1972)	2439.157	CS MON IN WELL 20IN DN @ C/L INT 70TH ST W + AVE L MKD (SEC COR 33 34 27 28 R13W T7N)	BL 2089
LANCASTR (1972)	2511.260	CS MON IN WELL 20IN DN @ C/L INT 70TH ST W + FUT AVE L-8 MKD (1/4 COR 33 34 R13W T7N)	BL 2090
LANCASTR (1972)	2435.909	CS MON IN WELL 14IN DN @ C/L INT AVE I + 95TH ST W MKD (1/4 COR 7 18 R13W T7N)	BL 2091
LANCASTR (1972)	2426.761	CSBM MON 6IN UP ON SW COR 90TH ST W + AVE G 25FT S + 25FT W C/L INT MKD (BM 119-16 1961)	BL 2094
LANCASTR (1972)	2420.334	L+T CONC STANDPIPE SE COR 90TH ST W + AVE F-8 32FT S + 60FT E C/L INT MKD (BM)	BL 2095

QUAD-YEAR	ELEV	DESCRIPTION (INCLUDE QUAD AND YEAR IN DESCRIPTION)	BM NUMBER
LANCASTR (1972)	2415.361	CS MON IN WELL 18IN DN @ C/L INT 90TH ST W + AVE F-8 MKD (1/4 COR 31 32 T8N R13W)	BL 2096
LANCASTR (1972)	2431.188	CS MON IN WELL 18IN DN @ C/L INT 90TH ST W + AVE E MKD (SEC COR 19 20 29 30 T8N R13W)	BL 2097
LANCASTR (1972)	2437.058	2IN IP 6IN DN ON SW COR 90TH ST W + AVE D-8 50FT S + 50FT W C/L INT	BL 2098
LANCASTR (1972)	2443.781	USC+GS MON FLUSH ON SW COR 90TH ST W + AVE C 80FT W + 27FT S C/L INT MKD (LITTLE BUTTE 1932)	BL 2099
LANCASTR (1972)	2440.744	USGS MON 3IN UP @ NE COR 90TH ST W + AVE B 25FT N + 30FT E C/L INT MKD (1 TWN 1963)	BL 2100
LANCASTR (1972)	2427.793	CS MON 14IN DN @ C/L INT AVE B + FUT 85TH ST W MKD (1/4 COR 5 8 R13W T8N)	BL 2101
LANCASTR (1972)	2407.639	CS MON 12IN DN @ C/L INT AVE B + FUT 75TH ST W MKD (1/4 COR 4 9 R13W T8N)	BL 2102
LANCASTR (1972)	2398.801	CSBM MON 6IN UP ON SW COR 60TH ST W + AVE H 107FT S + 25FT W C/L INT MKD (W 1153 1961)	BL 2103
LANCASTR (1972)	2382.560	USC+GS MON FLUSH ON SE COR 60TH ST W + FUT AVE C 170FT S + 40FT E C/L INT MKD (P 1154 1961)	BL 2104
LANCASTR (1972)	2360.075	USC+GS MON 4IN UP ON SE COR 60TH ST W + FUT AVE E 25FT S + 40FT E C/L INT MKD (A 1154 1961)	BL 2105
LANCASTR (1972)	2352.977	CS MON 6IN UP ON SE COR 60TH ST W + FUT AVE F-8 40FT S + 40FT E C/L INT MKD (BM 103-12A 1962)	BL 2106
LANCASTR (1972)	2357.412	USC+GS MON 4IN UP ON NE COR 60TH ST W + AVE H 40FT N + 25FT E C/L INT MKD (V 1153 1961)	BL 2107
LANCASTR (1972)	2356.416	CS MON IN WELL 12IN DN @ C/L INT 60TH ST W + AVE H MKD (SEC COR 2 3 10 11 R13W T7N)	BL 2108
LANCASTR (1972)	2468.495	CS MON IN WELL @ C/L INT AVE K + 90TH ST W MKD (SEC COR 19 20 29 30 R13W T7N)	BL 2111
LANCASTR (1972)	2583.308	CS MON IN WELL 8IN DN @ C/L INT AVE K + FUT 100TH ST W MKD (SEC COR 24 25 19 30 R13W R14W T7N)	BL 2112
LANCASTR (1972)	2530.718	CS MON 12IN DN @ C/L INT 100TH ST W + AVE J-8 MKD (1/4 COR 19 24 R13W R14W T7N) 2IN IP MKR 3FT UP 3FT N	BL 2113
LANCASTR (1972)	2402.214	CSBM MON IN SIDE OF RESERVOIR @ NW COR AVE D + 70TH ST W 110FT N + 30FT W C/L INT MKD (BM 119-6 1961)	BL 2129
BASELINE (1965)	2488.933	CSBM MON 72FT S + 32FT E C/L INT AVE D-8 + 110TH ST W MKD (BM 119-42 1961)	BL 2131
BASELINE (1965)	2481.336	CS MON (NE EDGE) IN WELL 18IN DN @ C/L INT 110TH ST W + AVE E MKD (SEC COR 23 24 25 26 R14W T8N)	BL 2132
BASELINE (1965)	2485.210	CSBM MON 6IN UP 117FT S + 30FT W C/L INT 110TH ST W + FUT AVE E MKD (BM 119-43 1961)	BL 2133
BASELINE (1965)	2494.208	CS MON IN WELL 18IN DN @ C/L INT 110TH ST W + FUT AVE E-8 30FT E PP 1222609E MKD (1/4 COR 25 26 R14W T8N)	BL 2134
BASELINE (1965)	2496.326	CSBM MON 6IN UP 110FT S + 30FT W C/L INT 110TH ST W + AVE E-8 110FT S PP 1222609E MKD (BM 119-44 1961)	BL 2135

QUAD-YEAR	ELEV	DESCRIPTION (INCLUDE QUAD AND YEAR IN DESCRIPTION)	BM NUMBER
BASELINE (1965)	2513.327	CS MON (NE EDGE) IN WELL 18IN DN @ C/L INT 110TH ST W + AVE F 25FT S + 30FT E PP 1222596 MKD (SEC COR 26 25 35 36 R14W T8N)	BL 2136
BASELINE (1965)	2516.157	CSBM MON 6IN UP 260FT S + 35FT W C/L INT 110TH ST W + FUT AVE F MKD (BM 119-45 1961)	BL 2137
BASELINE (1965)	2514.840	CS TRI STA MON 8IN UP 238FT S + 38FT W C/L INT AVE F + 110TH ST W MKD (DEL SUR G-1 ECC 1 1964)	BL 2138A
BASELINE (1965)	2487.868	CS MON (N EDGE) IN WELL 16IN DN @ C/L INT 110TH ST W + AVE F-8 MKD (1/4 COR 35 36 R14W T8N)	BL 2139
BASELINE (1965)	2490.818	CSBM MON 6IN UP 240FT S + 30FT W C/L INT 110TH ST W + AVE F-8 92FT N PP 1222581E MKD (BM 119-46 1961)	BL 2140
BASELINE (1965)	2493.045	CS MON (N EDGE) IN WELL 12IN DN @ C/L INT 110TH ST W + AVE G MKD (SEC COR 35 36 1 2 R14W T7N T8N)	BL 2141
BASELINE (1965)	2496.752	CSBM MON 6IN UP 145FT S + 30FT W C/L INT 110TH ST W + AVE G MKD (BM 119-20 1961)	BL 2142
BASELINE (1965)	2494.393	CS MON (W EDGE) IN WELL 12IN DN @ C/L INT 110TH ST W + AVE G-8 MKD (1/4 COR 1 2 R14W T7N)	BL 2143
BASELINE (1965)	2499.049	CSBM MON 35FT W C/L 110TH ST W + 365FT S AVE G-8 MKD (BM 119-21 1961)	BL 2144
BASELINE (1965)	2494.635	CS MON (E EDGE) IN WELL 24IN DN @ C/L INT 110TH ST W + AVE H MKD (SEC COR 1 2 11 12 T7N R14W)	BL 2145A
BASELINE (1965)	2497.882	CSBM MON 160FT S + 30FT W C/L INT 110TH ST W + AVE H MKD (BM 119-22 1961)	BL 2146
BASELINE (1965)	2500.044	CS MON (E EDGE) IN WELL 12IN DN @ C/L INT 110TH ST W + AVE H-8 MKD (1/4 COR 11 12 T7N R14W)	BL 2147
BASELINE (1965)	2501.568	CSBM MON 30FT E C/L 110TH ST W @ 90FT MKD (BM 119-23 1961)	BL 2148
BASELINE (1965)	2504.644	CS MON (W EDGE) IN WELL @ C/L INT 110TH ST W + AVE I-8 MKD (1/4 COR 13 14 T7N R14W)	BL 2149A
BASELINE (1965)	2505.583	CSBM MON 6IN UP 30FT W C/L 110TH ST W + 210FT S AVE I-8 174FT SW TP 49/30 MKD (BM 119-24 1961)	BL 2150
BASELINE (1965)	2535.556	USC+GS TRI STA MON FLUSH ON SW COR AVE J + 110TH ST W 45FT W + 40FT S C/L INT MKD (SUR 1932)	BL 2152
BASELINE (1965)	2581.374	CS MON (N EDGE) IN WELL @ C/L INT 110TH ST W + AVE J-8 (DIRT RD TO W) MKD (1/4 COR 23 24 R14W T7N)	BL 2154
BASELINE (1965)	2674.611	CS MON (E EDGE) IN WELL @ C/L INT AVE K + 110TH ST W MKD (SEC COR 23 24 26 25 T7N R14W)	BL 2156A
BASELINE (1965)	2681.649	CSBM MON 6IN UP ON SW COR AVE K + 110TH ST W 101FT S + 27FT W C/L INT MKD (BM 119-27 1961)	BL 2157
BASELINE (1965)	2342.118	L+T S END GAS PUMP ISL @ NE COR 90TH ST E + AVE E 75FT N + 80FT E C/L INT	BL 2165B
BASELINE (1965)	2347.605	CS MON FLUSH ON SW COR 90TH ST E + AVE E-8 60FT S + 27FT W C/L INT MKD (BM 116-7 1961)	BL 2166B
BASELINE (1965)	2384.082	CS MON IN WELL 8IN DN @ C/L INT 90TH ST E + AVE G-8 MKD (1/4 COR 5 6 R10W T7N) USE N EDGE	BL 2167B

QUAD-YEAR	ELEV	DESCRIPTION (INCLUDE QUAD AND YEAR IN DESCRIPTION)	BM NUMBER
BASELINE (1965)	2401.858	CS MON IN WELL 9IN DN @ C/L INT 90TH ST E + FUT AVE H-8 MKD (1/4 COR 7 8 T7N R10W)	BL 2168B
LANCASTR (1972)	2354.358	L+BN 3FT CONC BASE OF VENT PIPE 140FT E + 38FT N C/L INT AVE F + 85TH ST E	BL 2170
LANCASTR (1972)	2351.230	L+BN SW COR CONC BASE OF PUMP 385FT W + 85FT N C/L INT AVE F + 85TH ST E	BL 2171
LANCASTR (1972)	2339.519	L+T CONC WALK TO HSE @ NW COR 65TH ST E + AVE F 90FT N + 75FT W C/L INT 4FT N OF WOODEN PORCH	BL 2172
LANCASTR (1972)	2323.628	USC+GS MON 6IN UP @ SW COR AVE E + 60TH ST E 20FT S + 35FT W C/L INT MKD (S 1155 1961)	BL 2173
LANCASTR (1972)	2318.679	CSBM MON ON NW COR AVE E + 50TH ST E 30FT N + 49FT W C/L INT MKD (BM 106-130 1959)	BL 2174
LANCASTR (1972)	2317.128	CSBM MON 2IN UP 27FT S + 15FT E C/L INT AVE E + 40TH ST E MKD BM 106-132 1959	BL 2175
LANCASTR (1972)	2312.393	CSBM MON 6IN UP @ SE COR AVE E + 30TH ST E 32FT E + 27FT S C/L INT MKD (BM 106-134 1959)	BL 2176
LANCASTR (1972)	2344.414	L+T N CB AVE G 1FT E BCR @ NE COR AVE G + 30TH ST E 77FT E + 42FT N C/L INT	BL 2177
LANCASTR (1972)	2378.541	2IN IP (SW EDGE) 6IN DN @ NW COR AVE I + 30TH ST E 53FT W + 49FT N C/L INT	BL 2178
LANCASTR (1972)	2382.423	CSBM MON 6IN UP 58FT S C/L AVE I ON C/L PROD 35TH ST E MKD (BM 107-37 1961)	BL 2179
LANCASTR (1972)	2384.066	CSBM MON 6IN UP 12FT E + 25FT S C/L INT AVE I + 45TH ST E MKD (BM 107-35 1961)	BL 2180
LANCASTR (1972)	2388.723	USC+GS MON @ SE COR AVE I + 50TH ST E 94FT E + 27FT S C/L INT 3FT S PP 1122574E MKD (G 1154 1951)	BL 2181
LANCASTR (1972)	2392.684	CSBM MON 145FT W + 23FT N C/L INT AVE I + 55TH ST E MKD (BM 107-33 1961)	BL 2182
LANCASTR (1972)	2398.163	CSBM MON 6IN UP @ NW COR AVE I + 60TH ST E 70FT N + 27FT W C/L INT 3FT W PP 991726E MKD (BM 107-32 1961)	BL 2183
LANCASTR (1972)	2314.469	CSBM MON @ SW COR 25TH ST E (DIRT RD) + AVE E 5FT W + 65FT S C/L INT MKD (BM 106-135 1959)	BL 2184
LANCASTR (1972)	2304.767	CSBM MON 6IN UP 28FT E + 36FT S C/L INT AVE E + FUT 15TH ST E 5FT S PP 1270606E MKD (BM 106- 137 1959)	BL 2185
LANCASTR (1972)	2302.862	USC+GS MON 42FT S + 50FT E C/L INT AVE E + 10TH ST E MKD (F 1154 1961)	BL 2186
LANCASTR (1972)	2296.343	USC+GS MON 4IN UP @ NW COR AVE E + DIVISION ST 45FT N + 20FT W C/L INT MKD (E 1154 1961)	BL 2187
LANCASTR (1972)	2297.169	CSBM MON 6IN UP 90FT W + 35FT S C/L INT AVE E + 5TH ST W 4FT S PP 1270563E MKD (BM 106-141 1959)	BL 2188
BASELINE (1965)	2488.788	CS MON (S EDGE) IN WELL 8IN DN @ C/L INT 90TH ST E + AVE K-8 MKD (1/4 COR 29 30 R10W T7N)	BL 2189B
BASELINE (1965)	2511.976	CS MON IN WELL 8IN DN @ C/L INT 90TH ST E + FUT AVE L-8 MKD (1/4 SEC COR 31 32 R10W T7N)	BL 2190B

QUAD-YEAR	ELEV	DESCRIPTION (INCLUDE QUAD AND YEAR IN DESCRIPTION)	BM NUMBER
LANCASTR (1972)	2476.860	L+BN S END CONC PUMP ISL OF GAS STA @ NW COR SIERRA HWY + AVE L 105FT N + 80FT W C/L INT MKD (BM)	BL 2191
LANCASTR (1972)	2375.954	RDBM TAG E CB 1FT N BCR @ NE COR SIERRA HWY + AVE J 75FT N + 40FT E C/L INT	BL 2192
LANCASTR (1972)	2301.683	USC+GS REF MON 7IN UP 188FT W C/L SIERRA HWY + 2175FT N AVE F MKD (OBAN NO 1 1941)	BL 2193
LANCASTR (1972)	2306.339	CS MON IN WELL 8IN DN @ C/L INT AVE D + FUT 15TH ST W MKD (1/4 COR 16 21 R12W T8N)	BL 2194
LANCASTR (1972)	2335.774	2IN IP @ SW COR AVE H + DIVISION ST 50FT S + 50FT W C/L INT	BL 2195
LANCASTR (1972)	2374.755	L+T CONC WALK 3FT N + 2FT E OF SE COR BLDG 2201 AVE I 90FT N C/L + 1270FT W 25TH ST E	BL 2196
LANCASTR (1972)	2349.994	CS MON IN WELL 14IN DN @ C/L INT AVE G + FUT 55TH ST E MKD (1/4 COR 3 34 R12W T7N T8N)	BL 2197
LANCASTR (1972)	2347.281	CS MON IN WELL 12IN DN @ C/L INT AVE G + 50TH ST E MKD (SEC COR 4 3 33 34 R11W T7N T8N)	BL 2198
LANCASTR (1972)	2348.695	USC+GS MON 2IN UP @ SW COR AVE G + 50TH ST E 25FT W + 35FT S C/L INT MKD (J 1154 1961)	BL 2199
LANCASTR (1972)	2346.113	CS MON 18IN DN @ C/L INT AVE G + FUT 40TH ST E MKD (SEC COR 33 32 5 4 R11W T7N T8N)	BL 2200
LANCASTR (1972)	2318.389	CS MON IN WELL 8IN DN @ C/L INT AVE I + 25TH ST W MKD (1/4 COR 17 8 R12W T7N)	BL 2202
LANCASTR (1972)	2322.257	CS MON IN WELL @ C/L INT AVE I + 20TH ST W MKD (SEC COR 8 9 17 16 R12W T7N)	BL 2203
LANCASTR (1972)	2325.118	CSBM MON FLUSH IN PARKWAY @ NE COR AVE I + 15TH ST W 51FT N + 44FT E C/L INT MKD (BM 102-2 1957)	BL 2204
LANCASTR (1972)	2329.903	CS MON IN WELL @ C/L INT AVE I + 10TH ST W MKD (SEC COR 9 10 15 16 T7N R12W)	BL 2205
LANCASTR (1972)	2446.881	CS MON IN WELL 8IN DN @ C/L INT AVE L + 20TH ST W MKD (SEC COR 29 28 32 33 R12W T7N)	BL 2209
LANCASTR (1972)	2448.561	RDBM TAG W CB 1FT N BCR @ SW COR AVE L + 20TH ST W 40FT W + 76FT S C/L INT	BL 2210
LANCASTR (1972)	2379.554	RDBM TAG S CB 2FT W BCR @ SW COR LANCASTER BLVD + 10TH ST E 78FT W + 22FT S C/L INT	BL 2211
LANCASTR (1972)	2423.967	L+SQ SPK N CB @ NE COR AVE K + 4TH ST E 60FT E + 38FT N C/L INT MKD (AV 199)	BL 2212
LANCASTR (1972)	2423.218	CS TAG S CB AVE K 5FT E OF END CB 42FT S + 85FT E C/L INT AVE K + DIVISION ST 2FT N TP K10680Y	BL 2213
LANCASTR (1972)	2355.971	L+T E CB DIVISION ST 28FT E C/L ON C/L PROD LANCASTER BLVD FROM THE W 5FT N OF DRWY TO HIGH SCHOOL	BL 2214
LANCASTR (1972)	2361.667	L+T S CB 5FT W BCR @ SW COR DIVISION ST + MILLING ST 72FT W + 30FT S C/L INT MKD (BM)	BL 2215
LANCASTR (1972)	2361.432	L+T S CB 6FT E BCR @ E EDGE C B @ SE COR LANCASTER BLVD + DIVISION ST 30FT S + 61FT E C/L INT MKD (BM)	BL 2216

QUAD-YEAR	ELEV	DESCRIPTION (INCLUDE QUAD AND YEAR IN DESCRIPTION)	BM NUMBER
LANCASTR (1972)	2410.510	L+BN W CB 8FT N BCR @ NW COR FIG AVE + AVE K SERVICE RD 50FT N + 15FT W C/L INT	BL 2217
LANCASTR (1972)	2406.733	L+T N CB 7FT W OF C B @ NE COR 10TH ST W + AVE K 109FT E + 40FT N C/L INT	BL 2218
LANCASTR (1972)	2387.143	CS MON (S EDGE) IN WELL 18IN DN @ C/L INT AVE K + 25TH ST W MKD (1/4 COR 20 29 T7N R12W)	BL 2221
LANCASTR (1972)	2385.141	2IN IP CONC PLUG + CS TAG 4IN UP @ SW COR AVE K + 40TH ST W 50FT W + 50FT S C/L INT	BL 2222
LANCASTR (1972)	2378.284	CS MON (N EDGE) IN WELL 12IN DN @ C/L INT AVE K + 45TH ST W MKD (1/4 COR 24 25 T7N R13W)	BL 2223
LANCASTR (1972)	2314.081	CS MON IN WELL 14IN DN @ C/L INT AVE A + 20TH ST W TO THE N MKD (SEC COR 32 33 4 5 R12W T8N T9N)	BL 2224
LANCASTR (1972)	2314.714	CSBM MON @ SW COR AVE A + 20TH ST W 40FT S + 40FT W C/L INT MKD (BM 117-1 1961)	BL 2225
LANCASTR (1972)	2320.485	CS MON (W EDGE) IN WELL 14IN DN @ C/L INT AVE A + 25TH ST W (PROP) MKD (1/4 COR 32 5 R12W T8N T9N)	BL 2227
LANCASTR (1972)	2324.563	CSBM MON 30FT N C/L AVE A + 0.25MI W OF 25TH ST W (PROP) 30FT W OF POWER LINE MKD (BM 117-3 1961)	BL 2229
LANCASTR (1972)	2328.742	CS MON (E EDGE) IN WELL 14IN DN @ C/L INT AVE A + 30TH ST W MKD (SEC 31 32 6 5 T9N T8N R12W)	BL 2230
LANCASTR (1972)	2329.029	CSBM MON @ SW COR AVE A + 30TH ST W 43FT S + 43FT W C/L INT MKD (BM 117-4 1961)	BL 2231
LANCASTR (1972)	2337.506	CS MON IN WELL 14IN DN @ C/L INT AVE A + 35TH ST W (PROP) MKD (1/4 COR 31 6 T9N T8N R12W)	BL 2232
LANCASTR (1972)	2338.146	L+BN CONC FOOTING 4FT BARBED WIRE FENCE @ ANCHOR POST 40FT N + 10FT W C/L INT AVE A + 35TH ST W (PROP) MKD (BM)	BL 2233
LANCASTR (1972)	2344.983	CS MON (S EDGE) IN WELL 14IN DN @ C/L INT AVE A + 40TH ST W (PROP) MKD (SEC COR 36 31 1 6 T9N T8N R13W R12W)	BL 2234
LANCASTR (1972)	2344.836	CSBM MON 8IN UP @ SW COR AVE A + 40TH ST W (PROP) 71FT W + 40FT S C/L INT MKD (BM 117-6 1961)	BL 2235
LANCASTR (1972)	2352.231	CS MON (S EDGE) IN WELL 14IN DN @ C/L INT AVE A + 45TH ST W (PROP) MKD (1/4 COR 36 1 T9N T8N R13W)	BL 2236
LANCASTR (1972)	2352.903	L+T DRWY TO HSE @ NW COR AVE A + 45TH ST W (PROP) 147FT W + 67FT N C/L INT	BL 2237
LANCASTR (1972)	2357.846	CSBM MON 8IN UP 35FT S C/L AVE A + 0.2MI W 45TH ST W 32FT E PP 955226E MKD (BM 117-7 1961)	BL 2238
LANCASTR (1972)	2362.597	CS MON (E EDGE) IN WELL 14IN DN @ C/L INT AVE A + 50TH ST W MKD (SEC COR 35 36 2 1 T8N T9N R13W)	BL 2239
LANCASTR (1972)	2363.191	CSBM MON 8IN UP @ SW COR AVE A + 50TH ST W 40FT W + 44FT S C/L INT MKD (BM 117-8 1961)	BL 2240
LANCASTR (1972)	2371.840	CS MON (S EDGE) IN WELL 14IN DN @ C/L INT AVE A + 55TH ST W (PROP) MKD (1/4 COR 35 2 R13W T8N T9N)	BL 2241

QUAD-YEAR	ELEV	DESCRIPTION (INCLUDE QUAD AND YEAR IN DESCRIPTION)	BM NUMBER
LANCASTR (1972)	2372.406	CSBM MON 8IN UP @ SW COR AVE A + 55TH ST W (PROP) 30FT S + 50FT W C/L INT MKD (BM 117-9 1961)	BL 2242
LANCASTR (1972)	2380.438	USGS MON 8IN UP @ SW COR AVE A + 60TH ST W 30FT S + 36FT W C/L INT MKD (LINT CORNERS 1929)	BL 2243
LANCASTR (1972)	2380.990	CSBM MON 8IN DN @ SE COR AVE A + 60TH ST W 64FT S + 31FT E C/L INT MKD (BM 117-10A 1961)	BL 2244
LANCASTR (1972)	2380.554	CS MON (S EDGE) IN WELL 14IN DN @ C/L INT 60TH ST W + AVE A-8 MKD (1/4 COR 3 2 T8N R13W)	BL 2245
LANCASTR (1972)	2381.152	2IN IP 6IN UP @ SE COR AVE A-8 + 60TH ST W 50FT S + 50FT E C/L INT	BL 2246
LANCASTR (1972)	2368.475	RDBM TAG E CB ELM AVE @ NE COR ELM AVE + AVE J 4FT N DRWY 17FT E + 84FT N C/L INT	BL 2247
LANCASTR (1972)	2341.486	L+BN N CB SERVICE RD @ SW COR AVE J + OUT 8FT W BCR 42FT S + 54FT W C/L INT MKD	BL 2249
LANCASTR (1972)	2340.516	L+BN S CB SERVICE RD 8FT W BCR @ SW COR AVE J + 23RD ST W 47FT W + 71FT S C/L INT	BL 2250
LANCASTR (1972)	2340.031	CS MON (N EDGE) IN WELL 12IN DN @ C/L INT AVE J + 30TH ST W MKD (SEC COR 19 20 17 18 T7N R12W)	BL 2251
LANCASTR (1972)	2340.828	CS MON (N EDGE) IN WELL 12IN DN @ C/L INT AVE J + 35TH ST W (PROP) MKD (1/4 COR 18 19 T7N R12W)	BL 2252
LANCASTR (1972)	2346.869	CS MON (E EDGE) IN WELL 16IN DN @ C/L INT AVE J + 45TH ST W TO N MKD (1/4 COR 13 24 T7N R13W)	BL 2253
LANCASTR (1972)	2344.258	L+T N CB 8FT W BCR @ NW COR LANCASTER BLVD + 10TH ST W 27FT N + 60FT W C/L INT	BL 2255
LANCASTR (1972)	2351.760	L+BN S CB 3FT W BCR @ SW COR KETTERING ST + DIVISION ST 56FT W + 20FT S C/L INT MKD (BM)	BL 2256
LANCASTR (1972)	2350.557	CS TAG N CB 1.3FT W BCR @ NW COR KETTERING ST + REDWOOD AVE 48FT W + 20FT N C/L INT	BL 2257
LANCASTR (1972)	2349.496	L+T E CB 1.0FT S BCR @ SE COR KETTERING ST + TREVOR AVE 53FT S + 20FT E C/L INT	BL 2258
LANCASTR (1972)	2341.544	CS TAG W CB 2FT S BCR @ SW COR SIERRA HWY + JACKMAN ST 37FT S + 30FT W C/L INT	BL 2259
LANCASTR (1972)	2362.375	CS TAG SE COR CONC SLAB IN FRONT BLDG 44665 74FT S + 34FT W C/L INT NEWGROVE ST TO E + TREVOR AVE	BL 2261
LANCASTR (1972)	2361.576	L+T CONC PORCH @ N SIDE BLDG 44659 @ OUT YUCCA AVE + NEWGROVE ST 85FT W + 38FT INT	BL 2262
LANCASTR (1972)	2358.799	1 1/2IN IP CONC PLUG + BOLT @ C/L INT YUCCA AVE + NEWGROVE ST	BL 2263
LANCASTR (1972)	2365.244	L+T W CB 5FT S BCR @ SW COR CEDAR AVE + OLDFIELD ST 39FT S + 18FT W C/L INT	BL 2264
LANCASTR (1972)	2357.844	L+T CTR C B 30FT S C/L MILLING ST ON OUT SPEARMAN AVE FROM THE N	BL 2265
LANCASTR (1972)	2357.388	L+T W CB ISL 25FT N + 26FT E C/L INT YUCCA AVE + MILLING ST MKD (BM)	BL 2266
LANCASTR (1972)	2363.100	L+T 0.8FT S OF N EDGE WALK TO HSE 44544 @ SE COR ELM AVE + OLDFIELD ST 59FT S + 56FT E C/L INT	BL 2267

QUAD-YEAR	ELEV	DESCRIPTION (INCLUDE QUAD AND YEAR IN DESCRIPTION)	BM NUMBER
LANCASTR (1972)	2362.826	CSBM MON 30FT N C/L AVE G + 340FT E PROP 61 ST ST W MKD (BM 119-47 1961)	BL 2269
LANCASTR (1972)	2362.596	CS MON (S EDGE) IN WELL 18IN DN @ C/L INT AVE G + PROP 65TH ST W MKD (1/4 COR 34 3 R13W T8N T7N)	BL 2270
LANCASTR (1972)	2371.406	CS MON IN WELL 18IN DN @ C/L INT AVE G + 70TH ST W MKD (SEC COR 33 34 4 3 R13W T8N T7N)	BL 2271
LANCASTR (1972)	2374.080	CSBM MON 6IN UP @ NW COR AVE G + 70TH ST W 28FT N + 31FT W C/L INT MKD (BM 119-12 1961)	BL 2272
LANCASTR (1972)	2384.718	CS MON (S EDGE) IN WELL 14IN DN @ C/L INT 75TH ST W + AVE G MKD (1/4 COR 33 4 R13W T8N T7N)	BL 2273
LANCASTR (1972)	2387.444	CSBM MON 8IN UP 27FT N C/L AVE G + 259FT W OF 75TH ST W MKD (BM 119-13 1961)	BL 2274
LANCASTR (1972)	2398.776	CS MON (S EDGE) IN WELL 16IN DN @ C/L INT 80TH ST W + AVE G MKD (SEC COR 33 32 5 4 T7N T8N R13W)	BL 2275
LANCASTR (1972)	2401.398	CSBM MON @ NW COR 80TH ST W + AVE G 96FT W + 25FT N C/L INT MKD (BM 119-14 1961)	BL 2276
LANCASTR (1972)	2411.374	CS MON (N EDGE) IN WELL 14IN DN @ C/L INT AVE G + 85TH ST W (PROP) MKD (1/4 COR 32 5 T7N T8N R13W)	BL 2277
LANCASTR (1972)	2414.330	CSBM MON 6IN UP 230FT W + 25FT N C/L INT AVE G + 85TH ST W (PROP) MKD (BM 119-15 1961)	BL 2278
LANCASTR (1972)	2437.350	CS MON (N EDGE) IN WELL 28IN DN @ C/L INT PROP 95TH ST W + AVE G MKD (1/4 COR 31 6 T8N T7N R13W)	BL 2279
LANCASTR (1972)	2442.647	CSBM MON 6IN UP 315FT W + 25FT N C/L INT AVE G + PROP 95TH ST W MKD (119-17 1961)	BL 2280
LANCASTR (1972)	2450.156	CS MON (N EDGE) 6IN DN @ C/L INT AVE G + 100TH ST W (PROP) MKD (SEC COR 36 31 1 6 T8N T7N R13W R14W)	BL 2281
LANCASTR (1972)	2451.980	CSBM MON 8IN UP 25FT N + 180FT W C/L INT AVE G + 100TH ST W (PROP) MKD (BM 119-18 1961)	BL 2282
LANCASTR (1972)	2460.001	CS MON (S EDGE) IN WELL 12IN DN @ C/L INT AVE G + 105TH ST W (PROP) MKD (1/4 COR 36 1 R14W T8N T7N)	BL 2283
LANCASTR (1972)	2464.946	CSBM MON 6IN UP 25FT N + 395FT W C/L INT AVE G + 105TH ST W (PROP) 85FT E PP 430227E MKD (BM 119-19 1961)	BL 2284
LANCASTR (1972)	2359.359	CS MON IN WELL 10IN DN @ C/L INT PROP AVE J-8 + 30TH ST W MKD (1/4 COR 19 20 R12W T7N)	BL 2286
LANCASTR (1972)	2301.579	CS MON (W EDGE) IN WELL 24IN DN @ C/L INT AVE F + PROP 10TH ST W MKD (SEC COR 28 27 33 34 T8N R12W)	BL 2287
LANCASTR (1972)	2303.995	RDBM TAG 2FT E OF W EDGE S HDWL 1.06 25FT S C/L AVE F + 472FT W C/L PROP 10TH ST W	BL 2288
LANCASTR (1972)	2305.521	CSBM MON 8IN UP @ SW COR AVE F + PROP 15TH ST W 42FT W + 40FT S C/L INT MKD (AVA 14)	BL 2290
LANCASTR (1972)	2309.564	CSBM MON 8IN UP @ SW COR AVE F + 70TH ST W 19FT W + 43FT S C/L INT MKD (AVA 13)	BL 2292

QUAD-YEAR	ELEV	DESCRIPTION (INCLUDE QUAD AND YEAR IN DESCRIPTION)	BM NUMBER
LANCASTR (1972)	2313.423	CSBM MON @ SE COR AVE F + 25TH ST W 40FT E + 38FT S C/L INT MKD (AVA 12)	BL 2293
LANCASTR (1972)	2317.399	CS MON 6IN DN @ C/L INT AVE F + 30TH ST W MKD (SEC COR 30 29 31 32 T8N R12W)	BL 2295
LANCASTR (1972)	2322.148	CSBM MON 6IN UP @ SW COR AVE F + 35TH ST W 40FT W + 39FT S C/L INT MKD (AVA 10)	BL 2296
LANCASTR (1972)	2321.544	BOLT IN CONC 18IN DN @ C/L INT AVE F + 35TH ST W	BL 2297
LANCASTR (1972)	2324.739	CS MON (SW COR) IN WELL 8IN DN ON C/L AVE F 0.2MI W 35TH ST W @ NE COR FOX AIRFIELD	BL 2298
LANCASTR (1972)	2326.017	CS MON (N EDGE) IN WELL 18IN DN @ C/L INT AVE F + 40TH ST W MKD (SEC COR 25 36 30 31 R12W R13W T8N)	BL 2299
LANCASTR (1972)	2326.465	CSBM MON @ SW COR AVE F + 40TH ST W 34FT S + 34FT W C/L INT MKD (BM 103-7 1957)	BL 2300
LANCASTR (1972)	2332.580	CSBM MON 8IN UP ON C/L 45TH ST W 40FT S C/L AVE F MKD (AVA 8)	BL 2301
LANCASTR (1972)	2338.103	CSBM MON 40FT S + 40FT W C/L INT AVE F + 50TH ST W 36FT W OF W GATE POST TO FOX AIRFIELD MKD (AVA 7 1959)	BL 2302
LANCASTR (1972)	2338.913	CSBM MON 4IN UP 42FT S + 41FT W C/L INT AVE F + 50TH ST W 37FT W OF W GATE POST TO FOX AIRFIELD MKD (BM 103-9A 1962)	BL 2303
LANCASTR (1972)	2345.230	CSBM MON @ SE COR AVE F + 55TH ST W (PROP) 40FT S + 40FT E C/L INT MKD (AVA 6)	BL 2304
LANCASTR (1972)	2438.092	L+BN CONC SADDLE OF PIPE @ OLD PUMP HSE ON NE COR 90TH ST W + AVE A-8 40FT N + 53FT E C/L INT MKD (BM)	BL 2316
LANCASTR (1972)	2432.389	CSBM MON 6IN UP ON SE COR AVE A + 90TH ST W 90FT S + 21FT E C/L INT MKD (BM 117-16 1961)	BL 2317
LANCASTR (1972)	2430.798	CS MON IN WELL 8IN DN @ C/L INT AVE A + 90TH ST W MKD (5 6 31 32 T8N T9N R13W)	BL 2318
LANCASTR (1972)	2443.839	CSBM MON 4IN UP ON SE COR AVE A + 95TH ST W 27FT S + 75FT E C/L INT MKD (BM 117-17 1961)	BL 2319
LANCASTR (1972)	2442.316	CS MON IN WELL 14IN DN @ C/L INT AVE A + 95TH ST W MKD (31 6 T8N T9N R13W)	BL 2320
LANCASTR (1972)	2459.116	CSBM MON 6IN UP ON SE COR AVE A + 100TH ST W 28FT S + 100FT E C/L INT MKD (BM 117-18 1961)	BL 2321
LANCASTR (1972)	2458.186	CS MON IN WELL 14IN DN @ C/L INT AVE A + 100TH ST W MKD (36 31 1 6 T8N T9N R13W R14W)	BL 2322
LANCASTR (1972)	2472.996	CSBM MON 6IN UP ON SE COR AVE A + 105TH ST W 28FT S + 252FT E C/L INT MKD (BM 117-19 1961)	BL 2323
LANCASTR (1972)	2472.236	CS MON IN WELL 16IN DN @ C/L INT AVE A + 105TH ST W MKD (36 1 T8N T9N R14W)	BL 2324
BASELINE (1965)	2485.793	CSBM MON 4IN UP ON SE COR AVE A + 110TH ST W 28FT S + 75FT E C/L INT MKD (BM 117-20 1961)	BL 2325
BASELINE (1965)	2484.167	CS MON IN WELL 14IN DN @ C/L INT AVE A + 110TH ST W MKD (35 36 2 1 R14W T8N T9N)	BL 2326A

QUAD-YEAR	ELEV	DESCRIPTION (INCLUDE QUAD AND YEAR IN DESCRIPTION)	BM NUMBER
BASELINE (1965)	2487.146	CSBM MON 6IN UP 250FT N + 30FT W C/L INT AVE A-8 + 110TH ST W MKD (BM 119-36 1961)	BL 2327B
BASELINE (1965)	2486.062	CS MON IN WELL 14IN DN @ C/L INT AVE A-8 + 110TH ST W MKD (1/4 COR 2 1 T8N R14W)	BL 2328A
BASELINE (1965)	2482.882	CS MON IN WELL 30IN DN @ C/L INT AVE B + 110TH ST W MKD (2 1 11 12 R14W T8N)	BL 2329B
BASELINE (1965)	2485.176	CSBM MON 4IN UP ON NE COR AVE B + 110TH ST W 28FT N + 55FT E C/L INT MKD (BM 119-37 1961)	BL 2330B
BASELINE (1965)	2484.280	CS MON IN WELL 20IN DN @ C/L INT 110TH ST W + FUT AVE B-8 MKD (1/4 COR 11 12 R14W T8N)	BL 2331B
BASELINE (1965)	2486.579	CSBM MON 4IN UP @ SE COR 110TH ST W + FUT AVE B-8 125FT S + 28FT E C/L INT MKD (BM 119-38 1961)	BL 2332B
BASELINE (1965)	2483.486	CS MON IN WELL 24IN DN @ C/L INT 110TH ST W + AVE C MKD (11 12 13 14 R14W T8N)	BL 2333A
BASELINE (1965)	2486.188	CSBM MON 4IN UP @ SE COR 110TH ST W + AVE C 85FT S + 27FT E C/L INT MKD (BM 119-39 1961)	BL 2334A
BASELINE (1965)	2482.671	CS MON IN WELL 14IN DN @ C/L INT 110TH ST W + AVE C-8 MKD (1/4 COR 14 13 T8N R14W)	BL 2335B
BASELINE (1965)	2485.626	CSBM MON 6IN UP ON SW COR 110TH ST W + AVE C-8 95FT S + 25FT W C/L INT MKD (BM 119-40 1961)	BL 2336B
LANCASTER (1972)	2457.495	CS MON IN WELL 2IN DN @ C/L INT 30TH ST E + FUT AVE L-8 MKD (1/4 COR 31 32 T7N R11W)	BL 2361
LANCASTER (1972)	2444.390	CS MON IN WELL 12IN DN @ C/L INT 30TH ST E + FUT AVE L MKD (30 29 31 32 T7N R11W)	BL 2362
LANCASTER (1972)	2446.000	L+BN CONC FOOTING WATER TANK ON NW COR 30TH ST E + FUT AVE L 35FT N + 30FT W C/L INT MKD (BM)	BL 2363
LANCASTER (1972)	2432.711	CS MON IN WELL 6IN DN @ C/L INT 30TH ST E + FUT AVE K-8 MKD (1/4 SEC COR 30 29 T7N R11W)	BL 2364
LANCASTER (1972)	2419.777	CS MON IN WELL 24IN DN @ C/L INT 30TH ST E + AVE K MKD (SEC COR 19 20 29 30 T7N R11W)	BL 2365
LANCASTER (1972)	2421.830	CS MON IN WELL 12IN DN @ C/L INT AVE K + FUT 35TH ST E MKD (1/4 COR 20 29 R11W T7N)	BL 2367
LANCASTER (1972)	2427.585	CS MON IN WELL 18IN DN @ C/L INT AVE K + 40TH ST E MKD (20 21 29 28 R11W T7N)	BL 2368
LANCASTER (1972)	2431.045	CS MON IN WELL 14IN DN @ C/L INT AVE K + FUT 45TH ST E MKD (1/4 COR 21 28 R11W T7N)	BL 2369
LANCASTER (1972)	2434.821	CS MON IN WELL 12IN DN @ C/L INT AVE K + 50TH ST E MKD (SEC COR 21 22 28 27 R11W T7N) USE S EDGE	BL 2370
LANCASTER (1972)	2435.699	CSBM MON 6IN UP ON NE COR AVE K + 50TH ST E 88FT N + 37FT E C/L INT MKD (BM 120-6 1961)	BL 2371
LANCASTER (1972)	2435.626	2IN IP + SPK IN WELL 18IN DN @ C/L INT AVE K + 55TH ST E	BL 2372
LANCASTER (1972)	2441.725	CS MON IN WELL 18IN DN @ C/L INT AVE K + 60TH ST E MKD (SEC COR 22 23 26 27 R11W T7N)	BL 2373
LANCASTER (1972)	2443.936	L+BN CONC SLAB OF ELECT PANEL ON NW COR AVE K + FUT 65TH ST E 75FT N + 90FT W C/L INT MKD (BM)	BL 2374

QUAD-YEAR	ELEV	DESCRIPTION (INCLUDE QUAD AND YEAR IN DESCRIPTION)	BM NUMBER
LANCASTR (1972)	2445.286	L+BN CONC FOUNDATION ON NE COR AVE K + 70TH ST E 75FT N + 75FT E C/L INT MKD (BM)	BL 2375
LANCASTR (1972)	2433.076	L+BN CONC MOTOR MOUNT ON NW COR 70TH ST E + FUT AVE J-8 75FT N + 120FT W C/L INT MKD (BM)	BL 2376
LANCASTR (1972)	2419.025	RDBM MON IN WELL 8IN DN ON SW COR AVE J + 70TH ST E 40FT S + 55FT W C/L INT 2IN IP MKR 3FT UP 2FT S	BL 2377
LANCASTR (1972)	2408.937	2IN IP W/ CE TAG IN WELL 14IN DN @ C/L INT 70TH ST E + FUT AVE I-8 USE NW EDGE 2IN IP 14IN DN @ C/L INT 70TH ST E + FUT AVE I-8	BL 2378
LANCASTR (1972)	2328.109	CS MON 12IN DN @ C/L INT FUT AVE I-8 + FUT 40TH ST W MKD (1/4 COR 13 18 R12W R13W T7N)	BL 2445
LANCASTR (1972)	2326.843	CSBM MON 6IN UP ON NE COR FUT AVE E-8 + 50TH ST E 82FT N + 35FT E C/L INT MKD (BM 120-17 1961)	BL 2446
LANCASTR (1972)	2333.780	USC+GS MON 4IN UP ON NE COR 50TH ST E + AVE F 55FT E + 20FT N C/L INT MKD (K 1154 1961)	BL 2448
LANCASTR (1972)	2340.418	CSBM MON IN CONC 3IN UP ON NW COR FUT AVE F-8 + 50TH ST E 260FT N + 30FT W C/L INT MKD (BM 120- 15 1961)	BL 2450
LANCASTR (1972)	2339.494	CS MON (S EDGE) IN WELL 24IN DN @ C/L INT FUT AVE F-8 + 50TH ST E MKD (1/4 COR 33 34 R11W T8N)	BL 2451
LANCASTR (1972)	2317.129	CSBM MON 6IN UP @ SE COR AVE F + 30TH ST W 40FT E + 39FT S C/L INT MKD (AVA 11)	BL 2452
LANCASTR (1972)	2317.905	PM NE RIM 2IN IP WITH CONC PLUG + CS TAG 3IN UP ON SE COR 30TH ST W + AVE F-8 50FT S + 50FT E C/L INT	BL 2454
LANCASTR (1972)	2317.435	PM N RIM 2IN IP WITH CONC PLUG + CS TAG 3IN UP ON NW COR 30TH ST W + FUT AVE G 50FT N + 50FT W C/L INT	BL 2455
LANCASTR (1972)	2314.311	CS MON IN WELL 12IN DN @ C/L INT 30TH ST W + AVE H MKD (SEC COR 5 6 7 8 R12W T7N)	BL 2459
LANCASTR (1972)	2315.494	PM NW RIM 2IN IP WITH CONC PLUG + CS TAG 3IN UP ON SE COR 30TH ST W + AVE H 63FT S + 63FT E C/L INT	BL 2460
LANCASTR (1972)	2313.743	PM E RIM 2IN IP WITH CONC PLUG + CS TAG 3IN UP ON NW COR 30TH ST W + FUT AVE H-8 50FT S + 50FT W C/L INT	BL 2461
LANCASTR (1972)	2318.291	L+T W END S HDWL BRIDGE B 1091 20FT S C/L AVE I + 100FT E C/L 30TH ST W	BL 2463
LANCASTR (1972)	2367.415	CSBM MON 6IN UP 22FT E C/L 70TH ST W + 200FT S C/L FUT AVE F-8 MKD (BM 119-11 1961) 2IN IP 2FT UP 2FT W	BL 2464
LANCASTR (1972)	2367.743	PM N RIM 1 1/2IN IP WITH CONC PLUG + BRAD FLUSH ON SW COR 70TH ST W + FUT AVE F-8 50FT S + 50FT W C/L INT	BL 2465
LANCASTR (1972)	2368.548	PM S RIM 1 1/2IN IP WITH CONC PLUG + BRAD FLUSH ON NE COR 70TH ST W + FUT AVE F-8 50FT N + 50FT E C/L INT	BL 2466
LANCASTR (1972)	2372.260	CSBM MON 4IN UP ON SW COR 70TH ST W + AVE F 66FT S + 34FT W C/L INT MKD (BM 119-10 1961) 2IN IP 3FT UP 2FT E	BL 2467

QUAD-YEAR	ELEV	DESCRIPTION (INCLUDE QUAD AND YEAR IN DESCRIPTION)	BM NUMBER
LANCASTR (1972)	2379.869	PM NE RIM 1 1/2IN IP WITH CONC PLUG + BRAD 3IN UP ON NE COR AVE F + FUT 75TH ST W 50FT N + 50FT E C/L INT	BL 2468
LANCASTR (1972)	2387.567	CS MON IN WELL 12IN DN @ C/L INT AVE F + 80TH ST W MKD (SEC COR 28 29 32 33 R13W T8N)	BL 2470
LANCASTR (1972)	2388.809	PM W RIM 1 1/2IN IP WITH CONC PLUG + BRAD 2IN UP ON NW COR AVE F + 80TH ST W 50FT N + 50FT W C/L INT	BL 2471
LANCASTR (1972)	2389.060	CS MON IN WELL 8IN DN @ C/L INT 80TH ST W + AVE E-8 MKD (1/4 COR 29 28 R13W T8N)	BL 2472
LANCASTR (1972)	2387.708	PM S RIM 1 1/2IN IP CONC PLUG + BRAD FLUSH ON NE COR 80TH ST W + AVE E-8 50FT N + 50FT E C/L INT	BL 2473
LANCASTR (1972)	2404.313	CS MON IN WELL 8IN DN @ C/L INT AVE E + 80TH ST W MKD (SEC COR 20 21 28 29 R13W T8N)	BL 2474
LANCASTR (1972)	2416.839	CS MON IN WELL 10IN DN @ C/L INT AVE D-8 + 80TH ST W MKD (1/4 COR 20 21 R13W T8N)	BL 2475
LANCASTR (1972)	2372.705	RDBM TAG S CB 4FT E DRWY @ SE COR AVE OUT AVE 90FT E + 42FT S C/L INT	BL 2711
LANCASTR (1972)	2367.259	L+T N CB 6FT E BCR @ NE COR AVE J + FIG AVE 40FT N + 40FT E C/L INT	BL 2712
LANCASTR (1972)	2365.482	RDBM TAG W CB HARDWOOD AVE @ SW COR HARDWOOD AVE + AVE J IN FRONT OF FIRE HYD 76FT S + 20FT W C/L INT	BL 2713
BASELINE (1965)	2491.501	2IN IP (SE EDGE) CONC PLUG + CE TAG 2IN DN @ NW COR 70TH ST E + PROP AVE M 50FT N + 50FT W C/L INT	BL 2760A
BASELINE (1965)	2520.986	CS MON IN WELL 10IN DN @ C/L INT AVE M + 20TH ST W MKD (SEC COR 32 33 4 5 T6N T7N R12W)	BL 3196
BASELINE (1965)	2531.420	CSBM MON N CB AVE M 40FT N C/L + 173FT E C/L FUT 5TH ST W MKD (BM 104-1A 1967)	BL 3197
BASELINE (1965)	2471.981	CS MON IN WELL 8IN DN @ C/L INT AVE M + 40TH ST E MKD (SEC COR 32 33 5 4 T7N T6N R11W)	BL 3198
BASELINE (1965)	2486.109	CS MON IN WELL 8IN DN @ C/L INT FUT AVE M + 60TH ST E MKD (SEC COR 34 35 3 2 T7N T6N R11W)	BL 3199
BASELINE (1965)	2491.956	CS MON (N EDGE) IN WELL 8IN DN @ C/L INT 70TH ST E + FUT AVE M MKD (SEC COR 35 36 2 1 T6N T7N R11W)	BL 3200
LANCASTR (1972)	2419.901	CS MON 14IN DN @ C/L INT AVE A + 85TH ST W MKD (1/4 COR 5 32 T8N T9N R13W)	BL 3201
LANCASTR (1972)	2421.594	L+T @ SE COR DRWY TO HSE ON NE COR AVE A + 85TH ST W 55FT N + 180FT E C/L INT MKD (BM)	BL 3202
LANCASTR (1972)	2412.331	CS MON (E EDGE) IN WELL 17IN DN @ C/L INT AVE A + 80TH ST W MKD (SEC COR 4 5 32 33 T8N T9N R13W)	BL 3203
LANCASTR (1972)	2413.571	CSBM MON 6IN UP ON SE COR AVE A + 80TH ST W 26FT S + 110FT E C/L INT MKD (BM 117-14 1961)	BL 3204
LANCASTR (1972)	2403.794	CS MON IN WELL @ C/L INT AVE A + 75TH ST W MKD (1/4 COR 33 4 T8N T9N R13W)	BL 3205

QUAD-YEAR	ELEV	DESCRIPTION (INCLUDE QUAD AND YEAR IN DESCRIPTION)	BM NUMBER
LANCASTR (1972)	2406.535	CSBM MON ON SW COR AVE A + 75TH ST W 100FT S + 26FT W C/L INT MKD (BM 117-13 1961)	BL 3206
LANCASTR (1972)	2395.855	CS MON (E EDGE) IN WELL @ C/L INT AVE A + 70TH ST W MKD (SEC COR 3 4 33 34 T8N T9N R13W)	BL 3207
LANCASTR (1972)	2399.322	CSBM MON 8IN UP ON SW COR AVE A + 70TH ST W 115FT S + 30FT W C/L INT MKD (BM 117-12 1961)	BL 3208
LANCASTR (1972)	2388.701	CSBM MON 4IN UP ON SW COR AVE A + 65TH ST W 30FT S + 94FT W C/L INT MKD (BM 117-11 1961)	BL 3209
LANCASTR (1972)	2387.080	CS MON IN WELL @ C/L INT AVE A + 65TH ST W MKD (1/4 COR 3 34 T8N T9N R13W)	BL 3210
LANCASTR (1972)	2319.911	CSBM MON 6IN UP 33FT S C/L AVE A + 275FT E PROP 25TH ST W MKD (BM 117-2B 1967)	BL 3211
LANCASTR (1972)	2389.628	CS MON (N EDGE) IN WELL 8IN DN @ C/L INT 30TH ST E + LANCASTER BLVD MKD (1/4 COR 18 17 T7N R11W)	BL 3213
LANCASTR (1972)	2390.351	RDBM MON IN WELL 90FT S + 35FT E C/L INT 30TH ST E + LANCASTER BLVD	BL 3214
LANCASTR (1972)	2400.035	L+T IN CONC RET WALL @ NW COR AVE J + 30TH ST E 30FT N + 31FT W C/L INT	BL 3215
LANCASTR (1972)	2401.382	RDBM MON IN WELL 70FT S + 33FT E C/L INT AVE J + 30TH ST E	BL 3216
LANCASTR (1972)	2408.549	CS MON (N EDGE) IN WELL 14IN DN @ C/L INT 30TH ST E + AVE J-8 MKD (1/4 COR 19 20 T7N R11W)	BL 3217
LANCASTR (1972)	2410.403	2IN IP (E EDGE) + CS TAG 3IN UP @ SW COR 30TH ST E + AVE J-8 50FT S + 50FT W C/L INT	BL 3218
LANCASTR (1972)	2434.619	L+BN IN TOP STANDPIPE 33FT W C/L 30TH ST E + 205FT N AVE K-8 MKD (BM)	BL 3219
LANCASTR (1972)	2434.083	CS MON (S EDGE) IN WELL 8IN DN @ C/L INT AVE K + FUT 15TH ST E MKD (1/4 COR 24 25 T7N R12W)	BL 3220
LANCASTR (1972)	2437.338	CSBM MON 2IN UP 97FT E + 32FT S C/L INT 15TH ST E + AVE K MKD (BM 105-11 1958)	BL 3221
LANCASTR (1972)	2428.338	2IN IP (N EDGE) + CE TAG 2IN UP @ SW COR AVE K + 20TH ST E 50FT S + 50FT W C/L INT	BL 3222
LANCASTR (1972)	2427.242	CS MON (S EDGE) IN WELL 15IN DN @ C/L INT AVE K + 20TH ST E MKD (SEC COR 19 24 25 30 T7N R12W R11W)	BL 3223
LANCASTR (1972)	2419.268	2IN IP (W EDGE) + CE TAG 3IN UP 50FT N + 50FT W C/L INT 25TH ST E + AVE K	BL 3224
LANCASTR (1972)	2418.496	CS MON (E EDGE) IN WELL 7IN DN @ C/L INT AVE K + 25TH ST E MKD (1/4 COR 19 30 T7N R11W)	BL 3225
LANCASTR (1972)	2422.227	RDBM MON IN WELL 25FT N C/L AVE K + 315FT E FUT 35TH ST E 5FT W PP 1434069E	BL 3226
LANCASTR (1972)	2428.792	L+BN IN CONC FOOTING OF FENCE @ SE COR AVE K + 40TH ST E 60FT S + 61FT E C/L INT MKD (BM)	BL 3227
LANCASTR (1972)	2431.855	RDBM MON IN WELL 24FT N C/L AVE K + 303FT E FUT 45TH ST E 5FT W PP 536333E	BL 3228

QUAD-YEAR	ELEV	DESCRIPTION (INCLUDE QUAD AND YEAR IN DESCRIPTION)	BM NUMBER
LANCASTR (1972)	2436.889	RDBM MON IN WELL 51FT W + 24FT N C/L INT AVE K + 55TH ST E 5FT W PP 938251E	BL 3229
LANCASTR (1972)	2443.063	RDBM MON IN WELL 24FT N + 40FT W C/L INT AVE K + FUT 65TH ST E 4FT S 36IN STANDPIPE	BL 3231
LANCASTR (1972)	2441.736	CS MON (W EDGE) IN WELL 2FT DN @ C/L INT AVE K + 70TH ST E MKD (SEC COR 23 24 25 26 T7N R11W)	BL 3232
LANCASTR (1972)	2448.456	CS MON (N EDGE) IN WELL 12IN DN @ C/L INT AVE K + FUT 75TH ST E MKD (1/4 COR 24 25 T7N R11W)	BL 3233
LANCASTR (1972)	2448.418	RDBM MON IN WELL 25FT N + 138FT E C/L INT AVE K + FUT 75TH ST E 5FT W PP K10483Y	BL 3234
LANCASTR (1972)	2454.085	CS MON (S EDGE) IN WELL 16IN DN @ C/L INT AVE K + 80TH ST E MKD (24 25 19 30 T7N R11W R10W)	BL 3235
LANCASTR (1972)	2456.324	RDBM MON IN WELL 27FT N C/L AVE K + 174FT E 80TH ST E	BL 3236
LANCASTR (1972)	2470.231	L+T E SIDE CONC BASE VENT PIPE 33FT N C/L AVE K + 0.5MI E 80TH ST E OPP ENT TO RANCH 11FT E PP 1309682E	BL 3237
LANCASTR (1972)	2471.227	RDBM MON IN WELL 25FT N C/L AVE K + 0.5MI E 80TH ST E 5FT W PP K10463Y	BL 3238
LANCASTR (1972)	2349.969	L+BN CONC CB OF PARKING LOT ON SE COR AVE I + 60TH ST W 48FT S + 66FT E C/L INT MKD (BM)	BL 3239
LANCASTR (1972)	2351.841	CS MON IN WELL 16IN DN @ C/L INT 60TH ST W + PROP AVE H-8 MKD (1/4 COR 10 11 T7N R13W)	BL 3240
LANCASTR (1972)	2336.273	CS MON (N EDGE) IN WELL 18IN DN @ C/L INT 60TH ST E + AVE F MKD (SEC COR 27 26 34 35 T8N R11W)	BL 3243
LANCASTR (1972)	2449.674	PM E EDGE 2IN IP 2IN UP ON SE COR AVE D + 95TH ST W 37FT S + 4FT E C/L INT	BL 3244
LANCASTR (1972)	2324.443	CHIS X SE COR BOLT OF GAS RISER ON NE COR AVE D + 30TH ST W 40FT N + 60FT E C/L INT	BL 3245
LANCASTR (1972)	2366.527	CSBM MON FLUSH 65FT N + 34FT E C/L INT AVE I + PROP 15TH ST E MKD (BM 105-17 1958)	BL 3246
LANCASTR (1972)	2375.938	RDBM TAG N CB AVE I 3FT E OF END 40FT N + 5FT E C/L INT AVE I + PROP 25TH ST E	BL 3247
LANCASTR (1972)	2380.313	CS MON (E EDGE) IN WELL 21IN DN @ C/L INT AVE I + 35TH ST E MKD (1/4 COR 8 17 T7N R11W)	BL 3248
LANCASTR (1972)	2382.215	CS MON (W EDGE) IN WELL 10IN DN @ C/L INT AVE I + 40TH ST E MKD (8 9 17 16 T7N R11W)	BL 3249
LANCASTR (1972)	2387.336	CS MON (E EDGE) IN WELL @ C/L INT AVE I + 50TH ST E MKD (9 10 16 15 T7N R11W)	BL 3250
LANCASTR (1972)	2391.451	CS MON (W EDGE) IN WELL 24IN DN @ C/L INT AVE I + 55TH ST E MKD (1/4 COR 10 15 T7N R11W)	BL 3251
LANCASTR (1972)	2398.840	CS MON (E EDGE) IN WELL 6IN DN @ C/L INT AVE I + 70TH ST E MKD (SEC COR 11 12 14 13 T7N R11W)	BL 3252
LANCASTR (1972)	2370.643	CS MON (E EDGE) @ C/L INT AVE F + 70TH ST W MKD (SEC COR 28 27 33 34 T8N R13W)	BL 3253
LANCASTR (1972)	2379.546	CS MON (S EDGE) IN WELL 6IN DN @ C/L INT 75TH ST W + AVE F MKD (1/4 COR 28 33 T8N R13W)	BL 3254

QUAD-YEAR	ELEV	DESCRIPTION (INCLUDE QUAD AND YEAR IN DESCRIPTION)	BM NUMBER
LANCASTR (1972)	2418.407	USGS MON 3IN UP ON C/L AVE E-14 40FT W C/L 90TH ST W MKD (R 42 1929 RESET 1958)	BL 3255
LANCASTR (1972)	2410.143	2IN IP (E EDGE) + CE TAG 4IN UP ON SE COR 70TH ST E + FUT AVE I-8 45FT E + 52FT S C/L INT	BL 3256
LANCASTR (1972)	2418.256	CS MON (E EDGE) IN WELL 10IN DN @ C/L INT 70TH ST E + AVE J MKD (SEC COR 14 13 23 24 T7N R11W)	BL 3257
LANCASTR (1972)	2433.227	2IN IP (N EDGE) + CE TAG 3IN UP ON SE COR 70TH ST E + FUT AVE J-8 48FT S + 45FT E C/L INT	BL 3258
LANCASTR (1972)	2460.065	2IN IP (N EDGE) 3IN UP @ NW COR 70TH ST E + FUT AVE K-8 50FT N + 50FT W C/L INT	BL 3259
LANCASTR (1972)	2458.365	CS NON (N EDGE) IN WELL 18IN DN @ C/L INT 70TH ST E + FUT AVE K-8 MKD (26 25 T7N R11W)	BL 3260
LANCASTR (1972)	2468.591	CS MON (N EDGE) IN WELL 26IN DN @ C/L INT 70TH ST E + FUT AVE L MKD (SEC COR 26 25 35 36 T7N R11W)	BL 3262
LANCASTR (1972)	2481.199	CS MON (E EDGE) IN WELL 8IN DN @ C/L INT 70TH ST E + FUT AVE L-8 MKD (1/4 COR 35 36 T7N R11W)	BL 3263
LANCASTR (1972)	2485.091	2IN IP (N EDGE) + CE TAG FLUSH @ SE COR 70TH ST E + FUT AVE L-8 40FT S + 40FT E C/L INT	BL 3264
LANCASTR (1972)	2316.835	RDBM MON IN WELL 8IN DN ON SW COR 30TH ST W + PROP AVE G-8 63FT W + 57FT S C/L INT 2IN IP 3FT UP 2FT W	BL 3266
LANCASTR (1972)	2317.067	RDBM MON IN WELL 8IN DN ON NW COR 30TH ST W + PROP AVE G-8 63FT W + 57FT N C/L INT 2IN IP 3FT UP 2FT W	BL 3267
LANCASTR (1972)	2353.032	RDBM MON ON SW COR 60TH ST E + AVE G 34FT W + 25FT S C/L INT	BL 3268
LANCASTR (1972)	2371.963	RDBM MON ON SW COR 60TH ST E + AVE H 30FT W + 24FT S C/L INT 3FT W PP 538352E	BL 3269
LANCASTR (1972)	2399.813	CSBM MON 2IN UP ON NW COR 50TH ST E + LANCASTER BLVD 157FT N + 48FT W C/L INT MKD (BM 120-9A 1966)	BL 3270
LANCASTR (1972)	2398.550	CS MON (W EDGE) IN WELL 22IN DN @ C/L INT 50TH ST E + LANCASTER BLVD MKD (1/4 COR 16 15 T7N R11W)	BL 3271
LANCASTR (1972)	2415.644	CS MON (E EDGE) IN WELL 21IN DN @ C/L INT 50TH ST E + AVE J MKD (SEC COR 16 15 21 22 T7N R11W)	BL 3272
LANCASTR (1972)	2418.449	CSBM MON 4IN UP ON SE COR 50TH ST E + AVE J 127FT S + 48FT E C/L INT MKD (BM 120-8 1961)	BL 3273
LANCASTR (1972)	2425.952	2IN IP + SPK IN WELL 8IN DN @ C/L INT 50TH ST E + FUT AVE J-8	BL 3274
LANCASTR (1972)	2427.111	CSBM MON FLUSH ON SW COR 50TH ST E + FUT AVE J-8 114FT S + 40FT W C/L INT MKD (BM 120-7 1961)	BL 3275
LANCASTR (1972)	2444.359	CS MON (W EDGE) IN WELL 24IN DN @ C/L INT 50TH ST E + FUT AVE K-8 MKD (1/4 COR 28 27 T7N R11W)	BL 3276
LANCASTR (1972)	2447.703	CSBM MON 4IN UP ON SE COR 50TH ST E + FUT AVE K-8 79FT S + 36FT E C/L INT MKD (BM 120-5 1961)	BL 3277

QUAD-YEAR	ELEV	DESCRIPTION (INCLUDE QUAD AND YEAR IN DESCRIPTION)	BM NUMBER
LANCASTR (1972)	2454.525	RDBM MON ON NW COR 50TH ST E + AVE L 81FT N + 40FT W C/L INT 6FT S PP 800540E	BL 3278
LANCASTR (1972)	2455.074	CS MON (W EDGE) IN WELL 15IN DN @ C/L INT 50TH ST E + AVE L MKD (SEC COR 28 27 33 34 T7N R11W)	BL 3279
LANCASTR (1972)	2465.290	CS MON (N EDGE) IN WELL 28IN DN @ C/L INT 50TH ST E + FUT AVE L-8 MKD (1/4 COR 33 34 T7N R11W)	BL 3280
LANCASTR (1972)	2467.655	CSBM MON 8IN UP ON SE COR 50TH ST E + FUT AVE L-8 40FT S + 32FT E C/L INT MKD (BM 120-3 1961)	BL 3281
LANCASTR (1972)	2520.120	CS MON IN WELL 12IN DN @ C/L INT AVE K + 95TH ST W MKD (1/4 COR 19 30 T7N R13W)	BL 3282
LANCASTR (1972)	2350.276	RDBM MON IN WELL ON SW COR AVE G + FUT 55TH ST E 45FT W + 23FT S C/L INT 6FT W PP 1786549E	BL 3283
LANCASTR (1972)	2346.755	CS MON (E EDGE) IN WELL 22IN DN @ C/L INT AVE G + FUT 45TH ST E MKD (1/4 COR 33 4 T7N T8N R11W)	BL 3284
LANCASTR (1972)	2348.529	2IN IP + CE TAG 6IN UP ON SW COR AVE G + FUT 45TH ST E 50FT W + 50FT S C/L INT	BL 3285
LANCASTR (1972)	2346.263	RDBM MON ON NW COR AVE G + FUT 40TH ST E 30FT W + 55FT N C/L INT	BL 3286
LANCASTR (1972)	2346.334	CS MON (W EDGE) IN WELL 8IN DN @ C/L INT AVE G + FUT 35TH ST E MKD (1/4 COR 32 5 T7N T8N R11W)	BL 3287
LANCASTR (1972)	2346.282	CHIS X ON S EDGE 2IN IP WITH CE TAG 6IN UP ON SW COR AVE G + FUT 35TH ST E 50FT S + 50FT W C/L INT	BL 3288
LANCASTR (1972)	2339.972	CS MON (N EDGE) 14IN DN @ C/L INT FUT AVE G + FUT 25TH ST E MKD (1/4 COR 31 6 T7N T8N R11W)	BL 3289
LANCASTR (1972)	2341.705	CHIS X ON E EDGE 2IN IP WITH CE TAG 4IN UP ON SW COR FUT AVE G + FUT 25TH ST E 50FT S + 50FT W C/L INT	BL 3290
LANCASTR (1972)	2335.223	CS MON (N EDGE) 16IN DN @ C/L INT FUT AVE G + 20TH ST E MKD (SEC COR 36 31 1 6 T7N T8N R11W R12W)	BL 3291
LANCASTR (1972)	2338.038	2IN IP + CE TAG 6IN UP ON SW COR 20TH ST E + FUT AVE G 50FT S + 50FT W C/L INT	BL 3292
LANCASTR (1972)	2333.437	CHIS X ON S EDGE 2IN IP WITH CE TAG 8IN UP ON SE COR AVE G + FUT 15TH ST E 50FT S + 50FT E C/L INT	BL 3293
LANCASTR (1972)	2332.208	CS MON (E EDGE) 6IN DN @ C/L INT AVE G + FUT 15TH ST E MKD (1/4 COR 36 1 T7N T8N R12W)	BL 3294
LANCASTR (1972)	2328.347	CS MON (W EDGE) 16IN DN @ C/L INT AVE G + FUT 10TH ST E MKD (SEC COR 31 2 2 2 T7N T8N R12W)	BL 3295
LANCASTR (1972)	2330.605	2IN IP + CE TAG 6IN UP ON SW COR AVE G + FUT 10TH ST E 50FT S + 50FT W C/L INT	BL 3296
LANCASTR (1972)	2328.792	PM ON NE EDGE 2IN IP 3IN UP ON NE COR AVE G + FUT 5TH ST E 50FT N + 50FT E C/L INT	BL 3297
LANCASTR (1972)	2324.453	CS MON (SW EDGE) ³³ 6IN DN @ C/L INT FUT 5TH ST E MKD (1/4 COR 35 2 T7N T8N R12W)	BL 3298
LANCASTR (1972)	2380.687	L+BN CONC COLLAR OF FIRE HYD @ SW COR AVE K + 45TH ST W 36FT S + 60FT W C/L INT MKD (RD)	BL 3299

DISTURBED OUT

OUT

QUAD-YEAR	ELEV	DESCRIPTION (INCLUDE QUAD AND YEAR IN DESCRIPTION)	BM NUMBER
LANCASTR (1972)	2387.498	L+T 1FT W BCR @ NW COR AVE K + 30TH ST W 40FT N + 67FT W C/L INT	BL 3300
LANCASTR (1972)	2387.321	CS MON IN WELL 6IN DN @ C/L INT AVE K + 20TH ST W MKD (SEC COR 20 21 28 29 T7N R12W)	BL 3301
LANCASTR (1972)	2326.817	CS MON (S EDGE) IN WELL 10IN DN @ C/L INT 50TH ST E + FUT AVE E-8 MKD (27 28 T8N R11W)	BL 3302
LANCASTR (1972)	2333.325	CS MON (W EDGE) IN WELL 10IN DN @ C/L INT 50TH ST E + AVE F MKD (SEC COR 33 34 27 28 T8N R11W)	BL 3303
LANCASTR (1972)	2361.246	RDBM TAG S CB 38FT E BCR @ SE COR AVE J + 10TH ST W 113FT E + 42FT S C/L INT	BL 3304
LANCASTR (1972)	2359.097	CS MON IN WELL @ C/L INT 20TH ST W + AVE J-8 MKD (1/4 COR 20 21 T7N R12W)	BL 3305
LANCASTR (1972)	2359.678	CSBM MON 4IN UP ON SW COR 20TH ST W + AVE J-8 50FT S + 35FT W C/L INT MKD (BM 105-18 95)	BL 3306
LANCASTR (1972)	2331.922	RDBM TAG IN CB @ END CULDESAC ON SW COR 20TH ST W + LANCASTER BLVD 63FT S + 68FT W C/L INT	BL 3307
LANCASTR (1972)	2332.082	CS MON (E EDGE) IN WELL 6IN DN @ C/L INT 20TH ST W + LANCASTER BLVD MKD (1/4 COR 16 17 T7N R12W)	BL 3308
LANCASTR (1972)	2326.805	CS MON (W EDGE) IN WELL 8IN DN @ C/L INT AVE I + FUT 40TH ST W MKD (SEC COR 12 7 13 18 T7N R12W R13W)	BL 3309
LANCASTR (1972)	2329.976	CHIS X ON N EDGE OF 2IN IP WITH CE TAG 4IN UP ON SW COR FUT 40TH ST W + FUT AVE I-8 45FT W + 50FT S C/L INT	BL 3310
LANCASTR (1972)	2316.825	1-1/2IN IP 8IN DN ON SE COR 30TH ST W + FUT AVE E-8 50FT S + 60FT E C/L INT	BL 3311
LANCASTR (1972)	2316.674	L+BN CONC APRON OF GARAGE 160FT E C/L 30TH ST W + 250FT N C/L FUT AVE E-8 MKD (BM)	BL 3312
LANCASTR (1972)	2315.767	RDBM MON IN WELL 8IN DN ON SE COR 30TH ST W + AVE E 78FT S + 78FT E C/L INT 2IN IP 3FT UP 2FT E	BL 3313
LANCASTR (1972)	2315.221	1-1/2IN IP 8IN DN ON SW COR 30TH ST W + FUT AVE D-8 50FT S + 60FT W C/L INT	BL 3314
LANCASTR (1972)	2315.081	1-1/2IN IP 8IN DN ON NE COR 30TH ST W + FUT AVE D-8 50FT N + 60FT E C/L INT	BL 3315
LANCASTR (1972)	2327.125	1-1/2IN IP 6IN UP 50FT E C/L 30TH ST W ON C/L FUT AVE C-8	BL 3316
LANCASTR (1972)	2328.427	1-1/2IN IP 6IN UP ON SE COR AVE C + 30TH ST W 50FT S + 50FT E C/L INT	BL 3317
LANCASTR (1972)	2327.025	1-1/2IN IP 8IN DN ON SW COR AVE C + 30TH ST W 50FT S + 50FT W C/L INT	BL 3318
LANCASTR (1972)	2328.646	2IN IP 4IN UP ON SW COR AVE A-8 + 30TH ST W 40FT S + 50FT E C/L INT	BL 3321
LANCASTR (1972)	2328.350	2IN IP 4IN UP ON SW COR AVE A-8 + 30TH ST W 40FT S + 50FT W C/L INT	BL 3322
LANCASTR (1972)	2644.878	RDBM MON IN WELL ON NW COR AVE K + FUT 105TH ST W 47FT N + 45FT W C/L INT	BL 3323

QUAD-YEAR	ELEV	DESCRIPTION (INCLUDE QUAD AND YEAR IN DESCRIPTION)	BM NUMBER
LANCASTR (1972)	2644.107	CS MON (E EDGE) IN WELL 10IN DN @ C/L INT AVE K + FUT 105TH ST W MKD (1/4 COR 24 25 T7N R14W)	BL 3324
LANCASTR (1972)	2377.896	RDBM MON IN WELL 149FT W + 31FT S C/L INT AVE K + FUT 65TH ST W	BL 3325
LANCASTR (1972)	2376.859	CS MON (N EDGE) IN WELL 8IN DN @ C/L INT AVE K + FUT 65TH ST W MKD (1/4 COR 22 27 T7N R13W)	BL 3326
LANCASTR (1972)	2386.898	CS MON (S EDGE) IN WELL 8IN DN @ C/L INT AVE K + 60TH ST W MKD (SEC COR 22 23 26 27 T7N R13W)	BL 3327
LANCASTR (1972)	2388.211	RDBM TAG NE COR CONC BASE OF FIRE HYD @ SE COR AVE K + 60TH ST W 75FT S + 50FT E C/L INT	BL 3328
LANCASTR (1972)	2387.150	X ON S EDGE OF 2IN IP WITH CE TAG 2IN UP ON NW COR AVE K + FUT 55TH ST W 50FT N + 50FT W C/L INT	BL 3329
LANCASTR (1972)	2385.109	CS MON (N EDGE) IN WELL 17IN DN @ C/L INT AVE K + FUT 55TH ST W MKD (1/4 COR 23 26 T7N R13W)	BL 3330
LANCASTR (1972)	2544.956	L+BN CONC + ROCK HDWL ON SE COR 90TH ST W + AVE K-8 115FT S + 17FT E C/L INT MKD (BM)	BL 3332
LANCASTR (1972)	2640.516	USC+GS MON FLUSH ON NE COR 90TH ST W + AVE L 60FT N + 25FT E C/L INT MKD (Y 1044 1960)	BL 3333
LANCASTR (1972)	2347.857	R D MON IN WELL 8IN DN @ C/L INT LANCASTER BLVD + ELM AVE	BL 3335
LANCASTR (1972)	2348.372	RDBM TAG N CB 5FT E BCR @ NE COR LANCASTER BLVD + ELM AVE 40FT N + 47FT E C/L INT	BL 3336
LANCASTR (1972)	2351.970	R D MON IN WELL 8IN DN @ C/L INT SIERRA HWY + LANCASTER BLVD	BL 3337
BASELINE (1965)	2529.685	RDBM TAG 1FT S BCR 78FT S + 44FT E C/L INT AVE M + SIERRA HWY	BL 3629
BASELINE (1965)	2527.936	RDBM TAG 1FT W BCR 42FT S + 74FT W C/L INT AVE M + SIERRA HWY	BL 3630
BASELINE (1965)	2523.343	RD HD SPK 3FT W BCR INTO RET 42FT N + 6 FT E C/L INT AVE M + 10TH ST W	BL 3631
BASELINE (1965)	2583.807	LACS BM MON 6IN UP 34FT E C/L 110TH ST W + 2FT N C/L FUT AVE J-8 MKD BM 119-26 1961 2IN IP 3FT UP 2FT SW	BL 3632
BASELINE (1965)	2537.064	USC+GS REF MON 2IN UP 41FT S + 107FT W C/L INT 110TH ST W + AVE J MKD SUR 2 NO 5 1968	BL 3635
BASELINE (1965)	2487.641	LACS MON 6IN UP 91FT S + 28FT W C/L INT 110TH ST W + AVE D MKD BM 119-41 1961 MON LEANING	BL 3636
LANCASTR (1972)	2346.270	USC+GS BM MON IN W END OF BRIDGE B 1885 0.25MI E/O 25TH ST W MKD Q 1219 1971	BL 3639
LANCASTR (1972)	2337.651	LACS MON IN WELL 8IN DN @ C/L INT AVE E + 85TH ST E MKD 1/4 COR T8N R10W	BL 3640
LANCASTR (1972)	2338.072	LACS BM MON 3IN UP 55FT N + 10FT W C/L INT AVE E + 85TH ST E MKD BM 106-123 1959	BL 3641
LANCASTR (1972)	2335.495	LACS BM MON FL 25FT S + 27FT E C/L INT AVE E + 80TH ST E MKD BM 106-124 1959	BL 3642

QUAD-YEAR	ELEV	DESCRIPTION (INCLUDE QUAD AND YEAR IN DESCRIPTION)	BM NUMBER
LANCASTR (1972)	2333.982	LACS BM MON IN WELL 13IN DN @ C/L INT AVE E + 80TH ST E MKD 24 19 25 30 T8N R10W 11W USE N EDG	BL 3643
LANCASTR (1972)	2332.722	LACS BM MON 12IN UP 61FT S + 5FT E C/L INT AVE E + 75TH ST E MKD BM 106-125 1959	BL 3644
LANCASTR (1972)	2331.078	LACS BM MON IN WELL 12IN DN @ C/L INT AVE E + 75TH ST E MKD T8N R11W 1/4 24-25	BL 3645
LANCASTR (1972)	2329.055	LACS BM MON FL 65FT S + 18FT E C/L INT AVE E + 70TH ST E MKD BM 106-126 1959	BL 3646
LANCASTR (1972)	2327.014	LACS BM MON IN WELL 20IN DN @ C/L INT AVE E + 70TH ST E MKD 23 24 26 27 T8N R11W	BL 3647
LANCASTR (1972)	2327.347	LACS BM MON FL 45FT N + 20FT E C/L INT AVE E + 65TH ST E MKD BM 106-127 1959	BL 3648
LANCASTR (1972)	2325.518	LACS BM MON IN WELL 18IN DN @ C/L INT AVE E + 65TH ST E MKD 1/4 COR 23 18 USE SE EDGE	BL 3649
LANCASTR (1972)	2316.063	2IN IP CONC PLUG + CS TAG 50FT N + 50FT W C/L INT AVE E + 45TH ST E PROP	BL 3650
LANCASTR (1972)	2308.385	LACS MON IN WELL 10IN DN ON C/L INT AVE E + 20TH ST E MKD 24 19 25 30 T8N R11W R12W USE N EDGE	BL 3651
LANCASTR (1972)	2309.605	LACS BM MON FL 43FT S + 210FT W C/L INT AVE E + 20TH ST E PROP MKD BM 106-136A 1966	BL 3652
LANCASTR (1972)	2332.000	LACS BM MON IN WELL 8IN DN @ C/L INT AVE F + 45TH ST W PROP MKD T8N R13W 25 36	BL 3653
LANCASTR (1972)	2345.101	LACS MON IN WELL 8IN DN @ C/L INT AVE F + 55TH ST W PROP MKD 1/4 COR 26 35 R13W T8N	BL 3654
LANCASTR (1972)	2313.040	LACS MON IN WELL 8IN DN @ C/L INT AVE F + 25TH ST W MKD 29 32 R12W T8N	BL 3655
LANCASTR (1972)	2304.900	LACS MON IN WELL 8IN DN @ C/L INT AVE F + 15TH ST W PROP MKD 28 33 T8N R12W	BL 3656
LANCASTR (1972)	2480.807	USC+GS MON FL IN S LY LEG OF TOWER NO 57-4 46 FT N C/L AVE I + 134FT W C/L 105TH ST W MKD A 1220 1971	BL 3657
LANCASTR (1972)	2357.819	2IN IP + CE TAG 6IN UP 55FT S + 40FT E C/L INT AVE I + 65TH ST W PROP	BL 3658
LANCASTR (1972)	2317.792	USC+GS MON @ E END OF BRIDGE NO 81091 112FT E + 21FT N C/L INT AVE I + 30TH ST W MKD X 1219 1971	BL 3659
LANCASTR (1972)	2404.269	RDBM TAG IN N SIDE CONC BASE OLD WATER WELL 63FT N + 24FT W C/L INT AVE I + 75TH ST E	BL 3661
LANCASTR (1972)	2382.159	L + T 2FT N BCR INTO RETURN 66FT S + 30FT E C/L INT AVE J + DIVISION ST	BL 3662
LANCASTR (1972)	2419.478	RDBM MON IN WELL 65FT N + 28FT E C/L INT 30TH ST E + AVE K MKD BM 1972	BL 3663
LANCASTR (1972)	2442.785	RDBM TAG IN TOP OF CONC + RUBBLE WALL 37FT N + 117FT E C/L INT AVE K + 60TH ST E	BL 3664
LANCASTR (1972)	2404.686	CSBM MON FL 42FT N + 168FT W C/L INT 10TH ST W + AVE K MKD BM 105-6 1958	BL 3709
LANCASTR (1972)	2327.644	LACS MON FL @ C/L INT AVE B-8 + 30TH ST W MKD 1/4 COR 7 8 T8N R12W	BL 3710

QUAD-YEAR	ELEV	DESCRIPTION (INCLUDE QUAD AND YEAR IN DESCRIPTION)	BM NUMBER
LANCASTR (1972)	2329.678	LACS MON IN WELL 24IN DN @ C/L INT AVE B + 30TH ST W MKD SEC COR 5 6 7 8 T8N R12W	BL 3711
LANCASTR (1972)	2355.626	LACS MON IN WELL 6IN DN @ C/L INT 60TH ST W + PROP AVE E-8 MKD 1/4 COR 27 26 T8N R13W	BL 3712
LANCASTR (1972)	2376.016	LACS MON IN WELL 8IN DN @ C/L INT 60TH ST W + AVE D-8 MKD 1/4 COR 22 23 R13W T8N	BL 3713
LANCASTR (1972)	2470.807	2IN IP W/CE TAG 4IN UP 50FT S + 50FT E C/L INT 70TH ST E + FUT AVE L USE S EDGE	BL 3714
LANCASTR (1972)	2335.581	LACS MON IN WELL 6IN DN @ C/L INT 70TH ST E + FUT AVE E-8 MKD 1/4 COR 25 26 T8N R11W	BL 3717
LANCASTR (1972)	2336.612	CHIZ X ON E EDGE 2IN IP W/CONC PLUG + CE TAG 6IN UP 33FT S + 34FT W C/L INT 70TH ST E + AVE E-8	BL 3718
LANCASTR (1972)	2353.094	CHIZ X ON N EDGE 2IN IP W/CONC PLUG + CE TAG 4IN UP 25FT N + 25FT E C/L INT 70TH ST E + AVE F-8	BL 3719
LANCASTR (1972)	2350.953	LACS MON IN WELL 20IN DN @ C/L INT 70TH ST E + AVE F-8 MKD 1/4 COR 35 36 T8N R11W USE S EDGE	BL 3720
LANCASTR (1972)	2358.299	CE MON IN WELL 15IN DN @ C/L INT 70TH ST E + AVE G MKD SEC COR 35 36 2 1 T7N R11W USE N EDGE	BL 3721
LANCASTR (1972)	2359.349	CHIZ X ON E EDGE 2IN IP W/CONC PLUG + CE TAG 5IN UP 38FT S + 38FT W C/L INT 70TH ST E + AVE G	BL 3722
LANCASTR (1972)	2366.650	LACS MON IN WELL 24IN DN @ C/L INT 70TH ST E + AVE G-8 MKD 1/4 COR 2 1 T7N R11W USE W EDGE	BL 3723
LANCASTR (1972)	2368.461	CHIZ X ON N EDGE 2IN IP W/CONC PLUG + CE TAG 50FT S + 50FT W C/L INT 70TH ST E + AVE G-8	BL 3724
LANCASTR (1972)	2379.554	L + LACS TAG IN SW COR OF CONC WK 53FT N + 51FT E C/L INT 70TH ST E + AVE H	BL 3725
LANCASTR (1972)	2377.394	LACS MON IN WELL 15IN DN @ C/L INT 70TH ST E + AVE H MKD SEC COR 11 12 2 1 T7N R11W USE W EDG	BL 3726
LANCASTR (1972)	2389.497	LACS MON IN WELL 6IN DN @ C/L INT 70TH ST E + AVE H-8 MKD 1/4 COR 11 12 T7N R11W USE W EDGE	BL 3727
LANCASTR (1972)	2390.864	L + T IN S SIDE OF BOTTOM CONC STEP TO FRONT ENT OF CHURCH 101FT S + 101FT E C/L INT 70TH ST E + AVE H-8	BL 3728
LANCASTR (1972)	2402.253	LACS MON IN WELL 9IN DN @ C/L INT AVE F + 85TH ST W MKD 1/4 COR 29/32 T8N R13W USE E EDGE	BL 3729
LANCASTR (1972)	2356.179	LACS MON IN WELL 18IN DN @ C/L INT AVE G + 65TH ST E MKD 1/4 COR 25/24 T8N R11W USE S EDGE	BL 3730
LANCASTR (1972)	2356.697	RDBM MON IN WELL 30FT S + 15FT W C/L INT AVE G + 65TH ST E	BL 3731
LANCASTR (1972)	2363.372	CHIZ X IN E EDGE 2IN IP W/CE TAG 2IN UP 50FT N + 50FT W C/L INT AVE G + 75TH ST E	BL 3732
LANCASTR (1972)	2362.548	RDBM MON IN WELL 65FT N + 15FT W C/L INT AVE G + 75TH ST E 10FT S PP NO 1354798E	BL 3733
LANCASTR (1972)	2367.688	LACS MON IN WELL 12IN DN @ C/L INT AVE G + FUT 80TH ST E MKD SEC COR 36-31/1-6 T7N T8N R10W R11W USE S EDGE	BL 3734

QUAD-YEAR	ELEV	DESCRIPTION (INCLUDE QUAD AND YEAR IN DESCRIPTION)	BM NUMBER
LANCASTR (1972)	2367.269	1.5IN IP W/BR 14IN DN 50FT S + 50FT E C/L INT AVE G + FUT 80TH ST E	BL 3735
LANCASTR (1972)	2370.990	LACS MON IN WELL 14IN DN @ C/L INT AVE G + FUT 85TH ST E MKD 1/4 COR 36/1 T7N T8N R10W USE N ED	BL 3736
LANCASTR (1972)	2372.673	2IN IP W/CE TAG 2IN UP 50FT S + 50FT E C/L INT AVE G + 85TH ST E USE N EDGE	BL 3737
LANCASTR (1972)	2358.031	RDBM TAG IN NW COR CDNC BLOCK ON NE COR 50TH ST E + AVE G-8 40FT N + 65FT E C/L INT	BL 3738
LANCASTR (1972)	2357.977	LACS BM MON 4IN UP 65FT S + 30FT E C/L INT 50TH ST E + AVE G-8 MKD BM 120-13 1961	BL 3739
LANCASTR (1972)	2365.530	LACS MON 9IN DN @ C/L INT 50TH ST E + AVE H MKD 4-3/9-10 T7N R11W USE W EDGE	BL 3740
LANCASTR (1972)	2367.245	USC+GS MON FL 29FT S + 33FT E C/L INT 50TH ST E + AVE H MKD H-1154 1961	BL 3741
LANCASTR (1972)	2377.916	LACS BM MON FL 38FT N + 25FT W C/L INT 50TH ST E + AVE H-8 MKD BM 120-11 1961	BL 3742
LANCASTR (1972)	2377.101	LACS MON 12IN DN @ C/L INT 50TH ST E + AVE H-8 MKD 1/4 COR 9/10 T7N R11W	BL 3743